

## Installation Method

7

Finished installation.

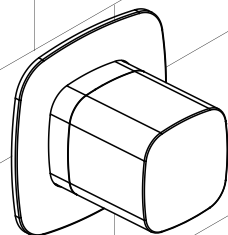

8

Checking the handle fixed correctly.

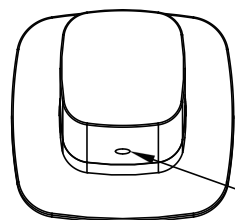

bottom fixing screw  
point to 6 o'clock .

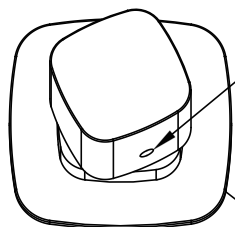

if not,reset the handle.

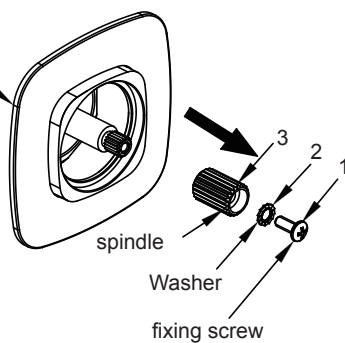

spindle

Washer

fixing screw

Make sure the bottom fixing screw always point to 6 o'clock when switch off.  
If not, disassemble the handle cap and parts #1 - #3 as arrow direction,  
rotate the spindle, until the handle could be set in correct direction.

# RAK

CERAMICS

Concealed Diverter  
Instruction Guide

## Installation Method

- 1 Drill installation slot in the wall, be aware the depth 60mm-80mm is including the thickness of ceramic tile.

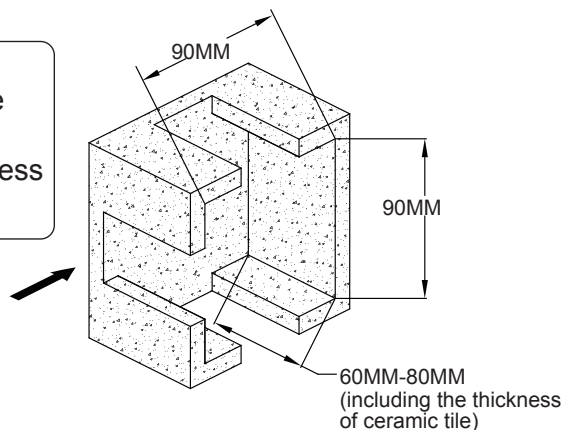

- 2 Connect the valve with plumbing, open inlet water, make the leaktightness test.

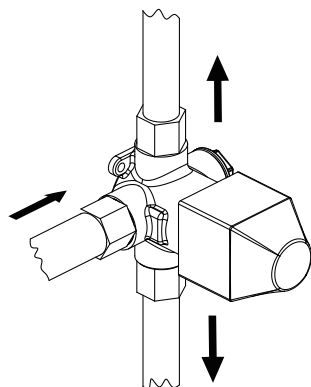

- 3 Fix the valve in the installation cube horizontally after spirit level measuring.

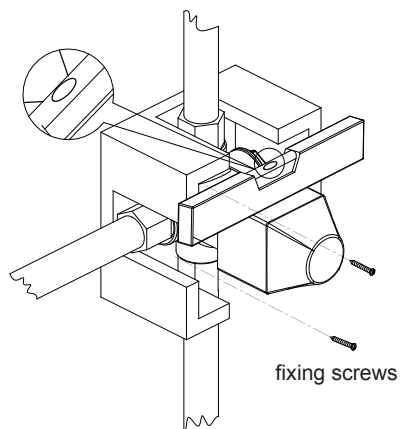

## Installation Method

- 4 Seal around with ceramic tiles, keep the front window.

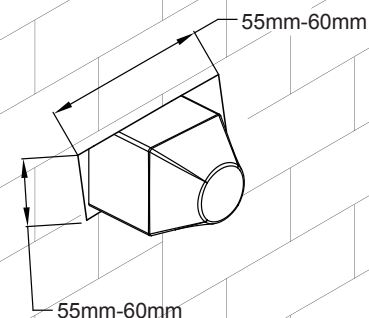

- 5 Take off the plastic cartridge cover.

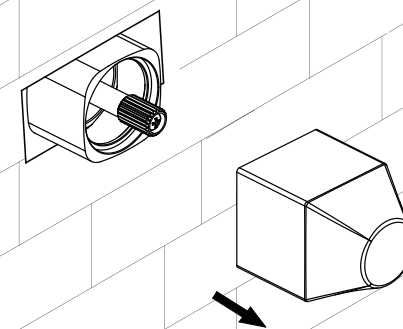

- 6 Install the front plate, base shroud and handle.

