

ARLINGTON 18/10 STAINLESS STEEL SINK

ARL1052/



Size: 1000 x 500 mm

The popular Arlington range is now available as a reversible option offering the choice of single bowl and 1.5 bowl configurations to choose from, providing the customer choice of drainer handing at point of installation. Arlington's streamlined drainer design provides a modern look which is further enhanced with a new waste kit, which features a contemporary waste cover to complement its overall look.

- Micro-sheen soft brushed finish
- Reversible drainer
- Hygienic rectangular overflow design

Waste kit and cover included

RANGEMASTER

SINKS & TAPS

Material	18/10 Stainless Steel
Material Gauge	0.9
Material Finish Bowl	Micro-Sheen™ Soft Brushed Finish
Material Finish Drainer	Micro-Sheen™ Soft Brushed Finish
Drainer Position	Reversible
Overall Length (mm)	1000
Overall Width (mm)	500
Main Bowl Length (mm)	340
Main Bowl Width (mm)	400
Main Bowl Depth (mm)	210
Second Bowl Length (mm)	170
Second Bowl Width (mm)	300
Second Bowl Depth (mm)	150
Tap hole Size (mm)	1 x 35
Waste Size (mm)	2 x 90
Waste Kit	Included with sink (2 x 90mm square BSW and overflow kit)
Min. Base Unit (mm)	600
Cutout Size Length (mm)	980
Cutout Size Width (mm)	480
Warranty Sinks (years)	25
Product Code	ARL1052/
Barcode	5015834055596

AGA Rangemaster continuously seeks improvements in specification, design and production of products and thus, alterations take place periodically. Whilst every effort is made to produce up-to date resources, the information included here is intended as a guide. Always refer to the product's installation instructions when fitting, installation work should be completed a professional tradesman.

ARLINGTON 18/10 STAINLESS STEEL SINK

ARL1052/

Technical Drawing

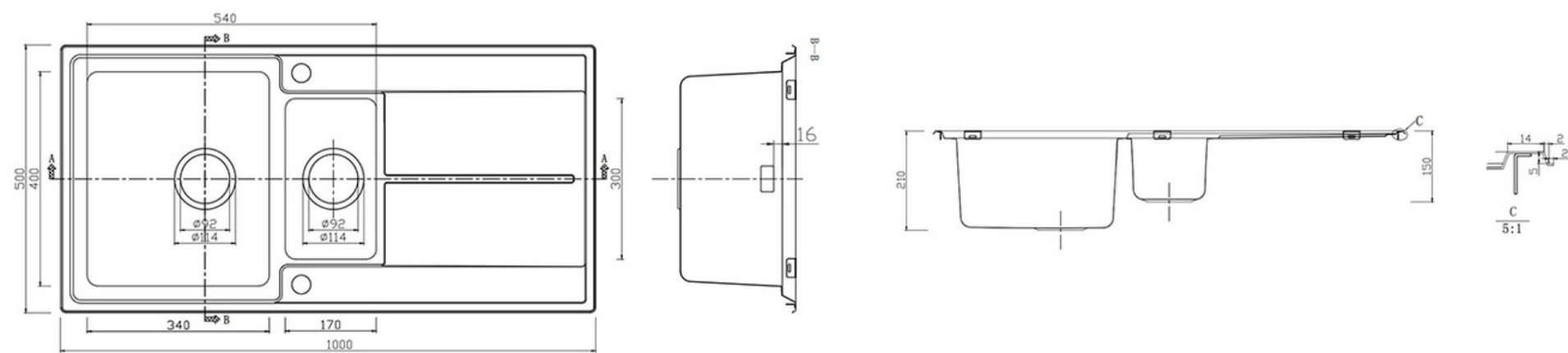

Date of download: July 02, 2024

AGA Rangemaster continuously seeks improvements in specification, design and production of products and thus, alterations take place periodically. Whilst every effort is made to produce up-to date resources, the information included here is intended as a guide. Always refer to the product's installation instructions when fitting, installation work should be completed a professional tradesman.

ARLINGTON 18/10 STAINLESS STEEL SINK

ARL1052/

Cut Out Template

Dimensions in mm. Not to scale.

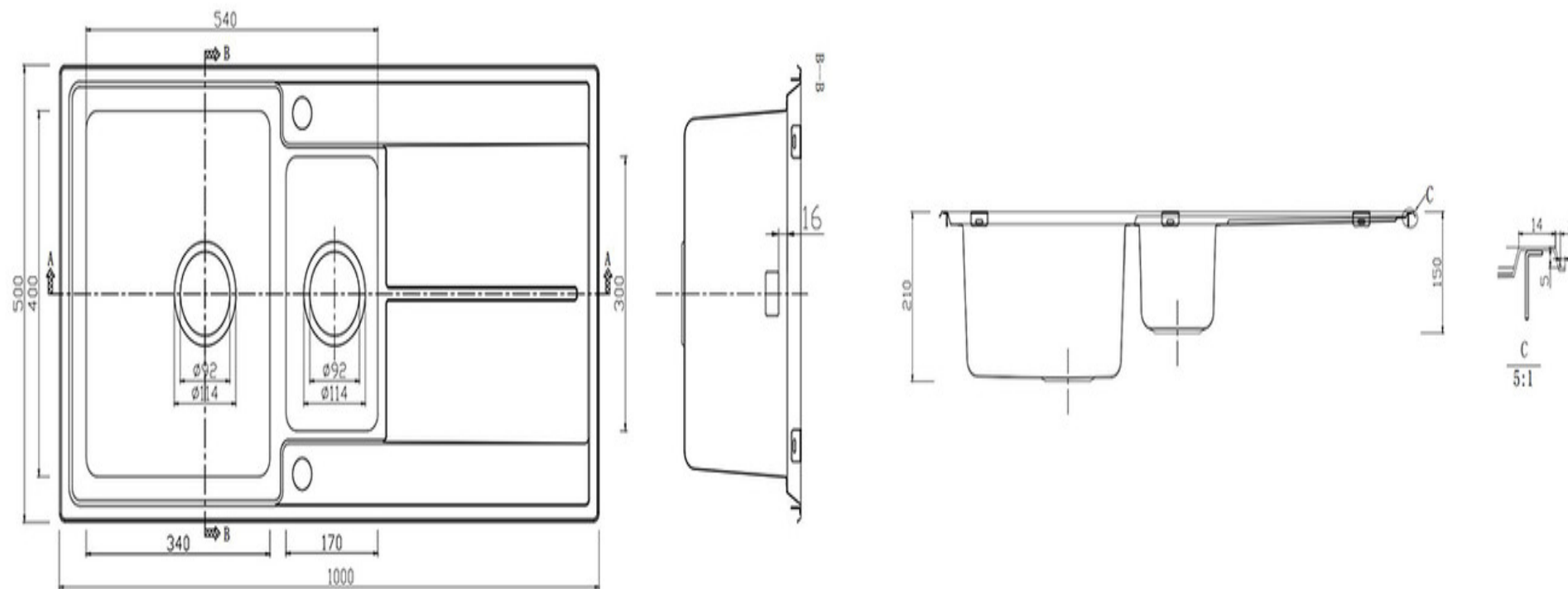

Date of download: July 02, 2024

AGA Rangemaster continuously seeks improvements in specification, design and production of products and thus, alterations take place periodically. Whilst every effort is made to produce up-to date resources, the information included here is intended as a guide. Always refer to the product's installation instructions when fitting, installation work should be completed a professional tradesman.