

TOPAZ IGNEOUS GRANITE SINK
 TOP1001CH/



Size: 1000 x 510 mm
 Featuring sharp geometric bowls and a classic lined drainer design, the Topaz range will look equally at home in a contemporary or traditional kitchen.

- Igneous granite material, 80% quartz & 20% acrylic
- Modern drainer design
- Reversible design
- Waste kit included

RANGEMASTER
 SINKS & TAPS

| | |
|-------------------------|--|
| Material | Igneous Granite |
| Material Gauge | - |
| Material Finish Bowl | - |
| Material Finish Drainer | - |
| Drainer Position | Reversible |
| Overall Length (mm) | 1000 |
| Overall Width (mm) | 510 |
| Main Bowl Length (mm) | 478 |
| Main Bowl Width (mm) | 421 |
| Main Bowl Depth (mm) | 200 |
| Second Bowl Length (mm) | - |
| Second Bowl Width (mm) | - |
| Second Bowl Depth (mm) | - |
| Tap hole Size (mm) | 1x 35 |
| Waste Size (mm) | 1 x 90 |
| Waste Kit | Included with sink (1 x 90mm BSW & overflow kit) |
| Min. Base Unit (mm) | 600 |
| Cutout Size Length (mm) | 980 |
| Cutout Size Width (mm) | 480 |
| Warranty Sinks (years) | 10 |
| Product Code | TOP1001CH/ |
| Barcode | 5015834056364 |

Date of download: July 23, 2025

AGA Rangemaster continuously seeks improvements in specification, design and production of products and thus, alterations take place periodically. Whilst every effort is made to produce up-to date resources, the information included here is intended as a guide. Always refer to the product's installation instructions when fitting, installation work should be completed a professional tradesman.

TOPAZ IGNEOUS GRANITE SINK

TOP1001CH/

Technical Drawing

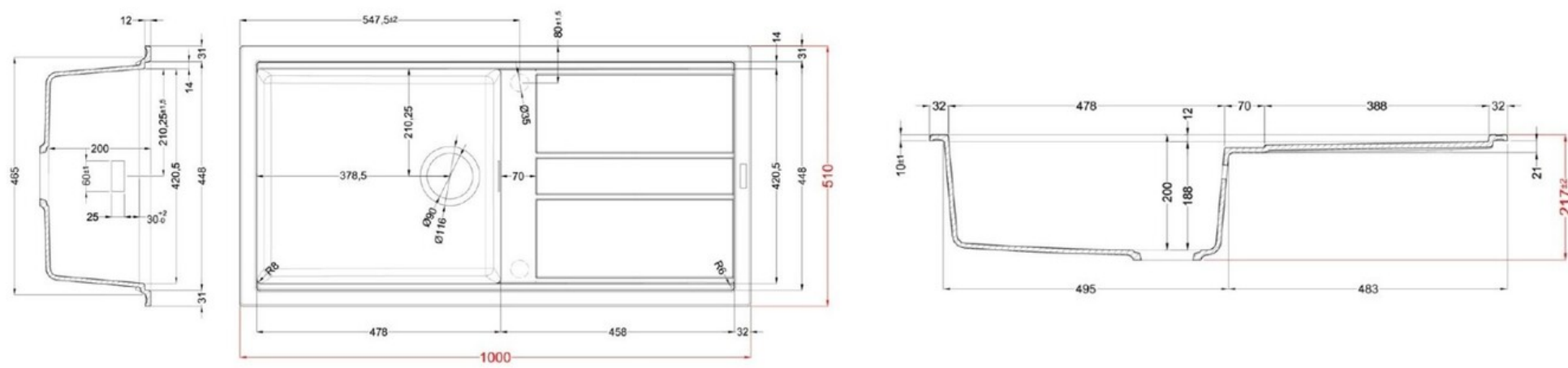

AGA Rangemaster continuously seeks improvements in specification, design and production of products and thus, alterations take place periodically. Whilst every effort is made to produce up-to date resources, the information included here is intended as a guide. Always refer to the product's installation instructions when fitting, installation work should be completed a professional tradesman.

TOPAZ IGNEOUS GRANITE SINK

TOP1001CH/

Cut Out Template

Dimensions in mm. Not to scale.

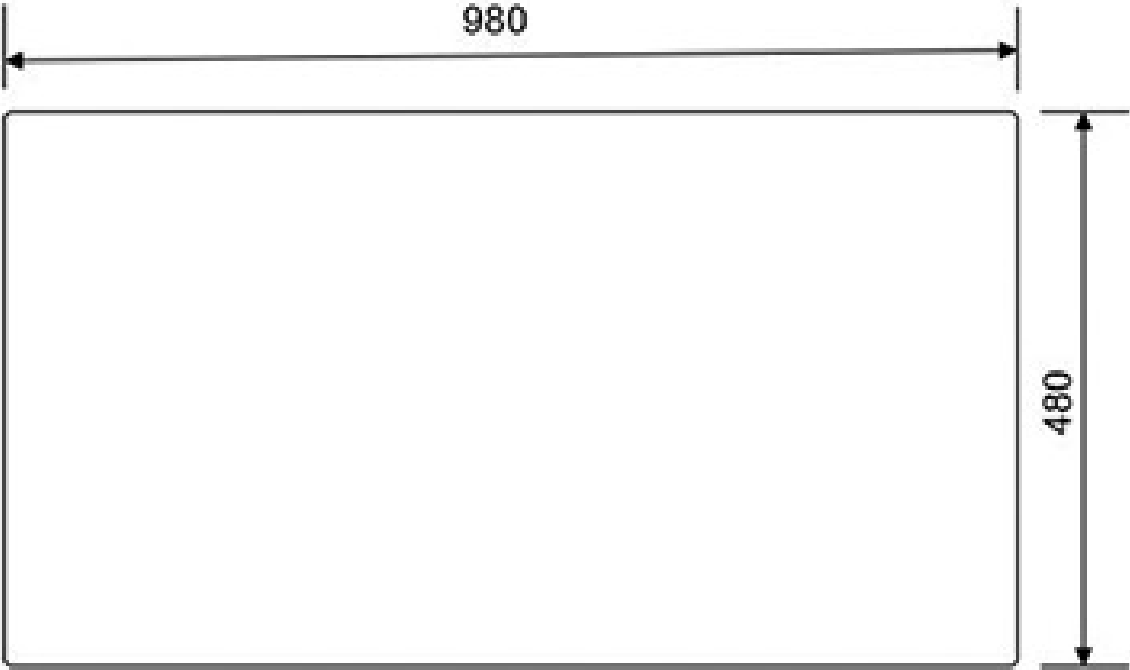

AGA Rangemaster continuously seeks improvements in specification, design and production of products and thus, alterations take place periodically. Whilst every effort is made to produce up-to date resources, the information included here is intended as a guide. Always refer to the product's installation instructions when fitting, installation work should be completed a professional tradesman.