



BIO SHIELD DISPOSER SERIES



1/2 HORSEPOWER

3 YEAR WARRANTY

Easy and Fast to Install

Rangemaster disposers feature Speed Master Mounting, an exclusive system that provides fast and economical installation.

Corrosion Proof

The Rangemaster WDU 700 model carries a lifetime warranty against failure due to corrosion.

Permanent Magnet Motors

Rangemaster motors offer maximum torque instantly with the power to cut through potential jams.

Compact and Lightweight

The compact design of your Rangemaster disposer allows inclusion where limited under counter space is available.

Removable Splash Guard

All Rangemaster models have a removable splash guard, ideal for easy cleaning and replacement.



BIO SHIELD (Antimicrobial) for ODOR PROTECTION!

Disposers are treated with an antimicrobial agent molded inside providing protection against odor causing bacteria growth.



THE TORQUE MASTER GRINDING SYSTEM is a combination of computer designed and balanced components working in unison to provide superior torque grind speed and long system life.

SPECIFICATIONS

SPECIFICATIONS	WDU 700
HORSEPOWER	1/2 HP
MOTOR SPEED RPM	2600 RPM
VOLTAGE	220/240v
AMPS	2.25
CYCLES	50/60
MOTOR TYPE	Permanent Magnet
SPLASH GUARD	EPDM
DRAIN OUTLET	Polycarbonate 940
GRIND RING	Stainless Steel
SWIVEL IMPELLERS	Stainless Steel
BALANCED TURNTABLE	Stainless Steel
BALANCED ARMATURE SHAFT	Stainless Steel
HOPPER	ABS
DRAIN HOUSING	PF
APPLIANCE PROTECTOR	Manual Reset
SINK FLANGE	PA66
STOPPER	PP
BEARINGS	Permanently Lubricated, Sleeve Type
SOUND SHELL	Partial
INDIVIDUAL SHIPPING WEIGHT	4.4 KG
MASTER CARTON WEIGHT (4 UNITS)	18.6 KG
MEASUREMENT A	354 MM
MEASUREMENT B	161 MM
MEASUREMENT C	132 MM
MEASUREMENT D	137 MM
MEASUREMENT E	70 MM
LIFETIME CORROSION GUARANTEE	Yes

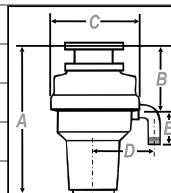

Rangemaster Disposers are compliant with the EC Directive regards RoHS.