

INTENSE DUAL LEVER TAP BRUSHED COPPER

TID1BC/

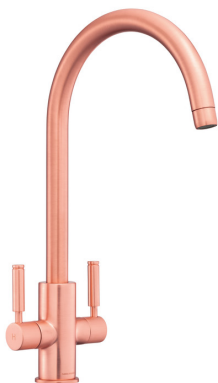

A bold, streamlined design. The Intense kitchen tap creates the ultimate statement piece in any contemporary kitchen. With the choice of five finishes; Intense is available in chrome, brushed, brushed copper, graphite and matt black.

- Suitable for medium pressure water systems emitting a minimum pressure of 0.5 bar or above
- Featuring an anti-splash spout with honeycomb aerator design which mixes air with water to emit a water flow with no splash

RANGEmaster
sinks & taps

| | |
|---|-------------------------------|
| Overall Height (mm) | 398 |
| Spout Reach (mm) | 216 |
| Spout Height (mm) | 273 |
| Spout Rotation Range | 360° |
| Handle Type | Dual Lever |
| Colour | Brushed Copper |
| Bar Pressure Suitability | Medium Pressure |
| Min. Bar Pressure | 0.50 |
| Max. Bar Pressure | 5.50 |
| Mixed Flow Rate at 3 Bar Pressure (l/min) | 14.01 |
| Flow Type | Single Flow |
| Recommended Hot Water Temperature | 46°C |
| Maximum Hot Water Temperature | 70°C |
| Handle Control | Quarter Turn |
| Centre Distance (mm) | - |
| Cartridge Type | Ceramic Disc Cartridge |
| Aerator Type | Honeycomb Aerator |
| Inlet Pipes | 1/2" Stainless Flexible Hoses |
| Anti-Splash Spout | Yes |
| Pull Out Spray | No |
| WRAS Approved | No |
| Product Code | TID1BC/ |
| Barcode | 5015834050133 |

Date of download: July 20, 2023

AGA Rangemaster continuously seeks improvements in specification, design and production of products and thus, alterations take place periodically. Whilst every effort is made to produce up to date resources, the information included here is intended as a guide. Always refer to the installation instructions when fitting, installation work should be completed by a professional tradesman.

INTENSE DUAL LEVER TAP BRUSHED COPPER

TID1BC/

Technical Drawing

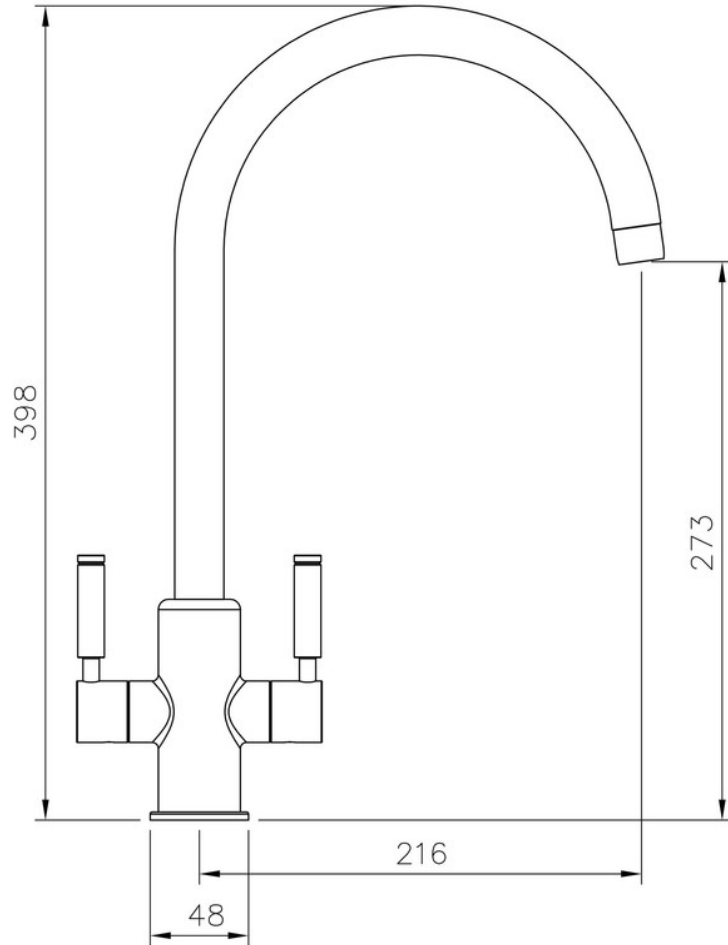

Date of download: July 20, 2023

AGA Rangemaster continuously seeks improvements in specification, design and production of products and thus, alterations take place periodically. Whilst every effort is made to produce up to date resources, the information included here is intended as a guide. Always refer to the installation instructions when fitting, installation work should be completed by a professional tradesman.