

# SAGITTARIUS

## TAPS & SHOWERING

<b>Construction</b>	Brass Body, Zinc-alloy Handle
<b>Finishes</b>	Brushed Brass
<b>Product Type</b>	Contemporary
<b>Water Pressure Tested Between</b>	Min. 0.2 bar, Max. 6.0 bar
<b>Standards</b>	Complies with BS6920, BS EN200
<b>Certification</b>	Manufactured to comply with WRAS and ACS
<b>Cartridge Fitting</b>	35mm Triduon® Ceramic disc cartridge UK: M10 x 350mm G½" BSP Female Flexi Tails EU: M10 x 350mm G3/8" BSP Female Flexi Tails
<b>Aerator</b>	Neoperl Adjustable Slim Aerator
<b>Guarantee</b>	10 years against manufacturing faults (excluding serviceable parts)
<b>Additional Information</b>	Supplied with G1¼" sprung waste (UK only); Triduon® volume limiter (optional)

### RAVENNA MINI BASIN MONO MIXER

RA/186/C



#### Operating Water Pressure



**LOW PRESSURE**  
0.2 - 0.5 bar



**COMBI BOILER**



**HIGH PRESSURE**  
1.2 - 1.5+ bar

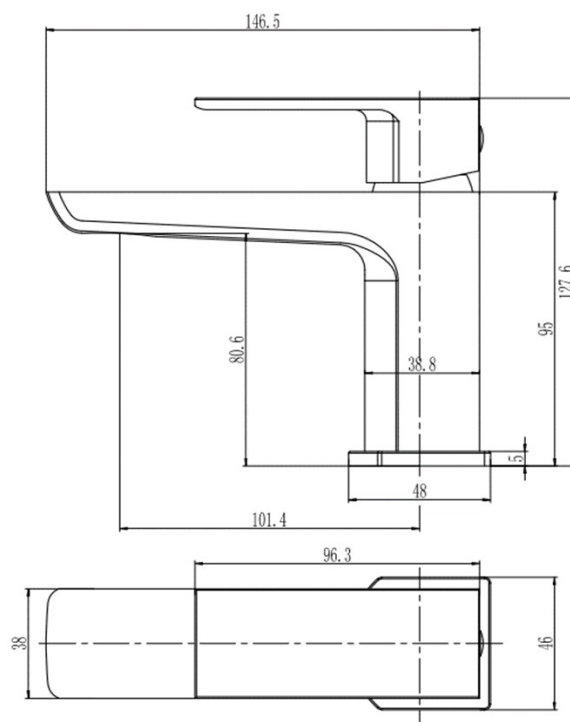

The information contained on this page was correct at the date of issue. Fitting dimensions are provided as a guide only. Some variation may occur due to manufacturing tolerances. We pursue a policy of continuing improvement in design and performance of our products and so reserve the right to change specifications without prior notice

FOR FURTHER ADVICE PLEASE CONTACT :-

SAGITTARIUS LTD UNIT 1 LOWER VICTORIA STREET—CHADDERTON—OLDHAM—OL9 9TU TEL:0616 6202029

EMAIL:TECHNICAL@SAGITTARIUSTAPS.CO.UK

**Flow Rates** (Litres per minute)

System Pressure	0.1 Bar	0.2 Bar	0.3 Bar	0.5 Bar	1.0 Bar	1.5 Bar	2.0 Bar	3.0 Bar	4.0 Bar	5.0 Bar
	3.0	4.1	4.9	6.1	8.5	10.3	11.9	14.5	16.7	18.7

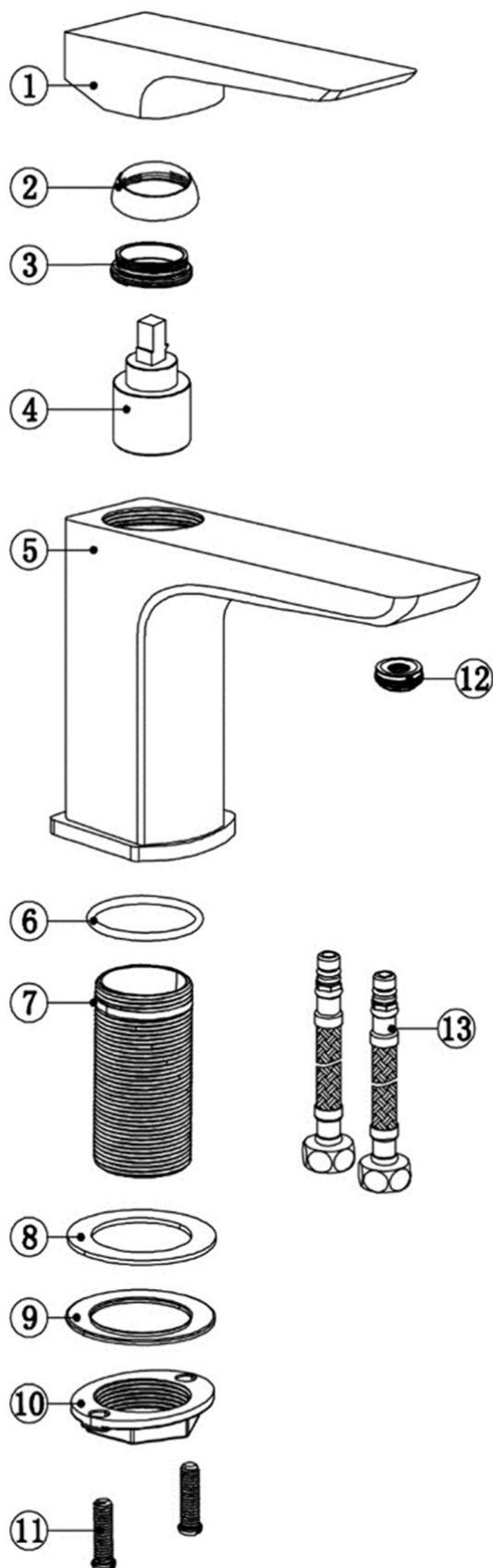

NO.	ITEM	QTY
1	Handle	1
2	Shroud	1
3	Cartridge Nut	1
4	35mm Cartridge	1
5	Tap Body	1
6	O-ring	2
7	Threaded Fixing Tube	1
8	Washer	1
9	Stainless steel plate	1
10	Locking Nut	1
11	Locking Screw	2
12	Aerator	1
13	Flexi tails	2

FOR FURTHER ADVICE PLEASE CONTACT :-

SAGITTARIUS LTD UNIT 1 LOWER VICTORIA STREET—CHADDERTON—OLDHAM—OL9 9TU TEL:0616 6202029

EMAIL:TECHNICAL@SAGITTARIUSTAPS.CO.UK