

SAGITTARIUS

TAPS & SHOWERING

Construction	Brass Body CuZn40Pb2, EN CW617N (equivalent to BS CZ122); zinc alloy handle
Finishes	Chrome plated to BS EN 248
Product Type	Contemporary
Water Pressure	Min. 1.0 bar, Max. 6.0 bar
Standards	Complies with BS5412, BS EN200
Certification	-
Aerator	Aerator spout
Cartridge	40mm Ceramic disc cartridge
Fitting	Brass 3/4" BSP
Packaging	94.5 x 34.5 x 40cm / carton (4 boxes / carton)
Guarantee	10 years against manufacturing faults (excluding serviceable parts).
Additional Information	Supplied ABS handset & 1.5m SS304 shower hose

ERGO FLOOR MOUNTED

BSM CHROME

EL/214/C

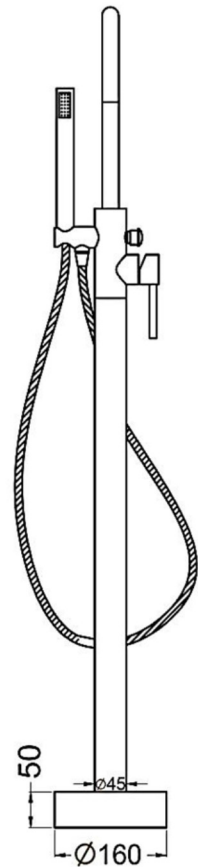
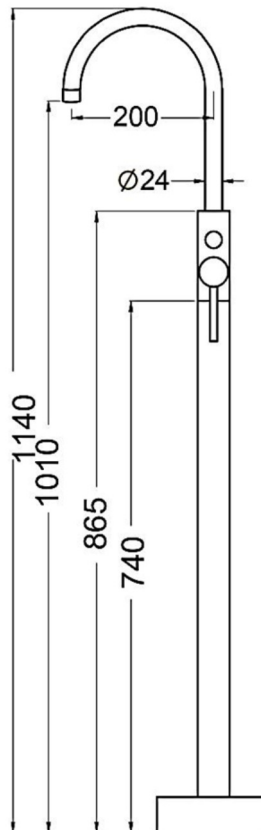

The information contained on this page was correct at the date of issue. Fitting dimensions are provided as a guide only. Some variation may occur due to manufacturing tolerances. We pursue a policy of continuing improvement in design and performance of our products and so reserve the right to change specifications without prior notice

FOR FURTHER ADVICE PLEASE CONTACT :-

SAGITTARIUS LTD UNIT 1 LOWER VICTORIA STREET—CHADDERTON—OLDHAM—OL9 9TU TEL:0616 6202029

EMAIL:TECHNICAL@SAGITTARIUSTAPS.CO.UK

EXPLODED PARTS DRAWING EL/214/C

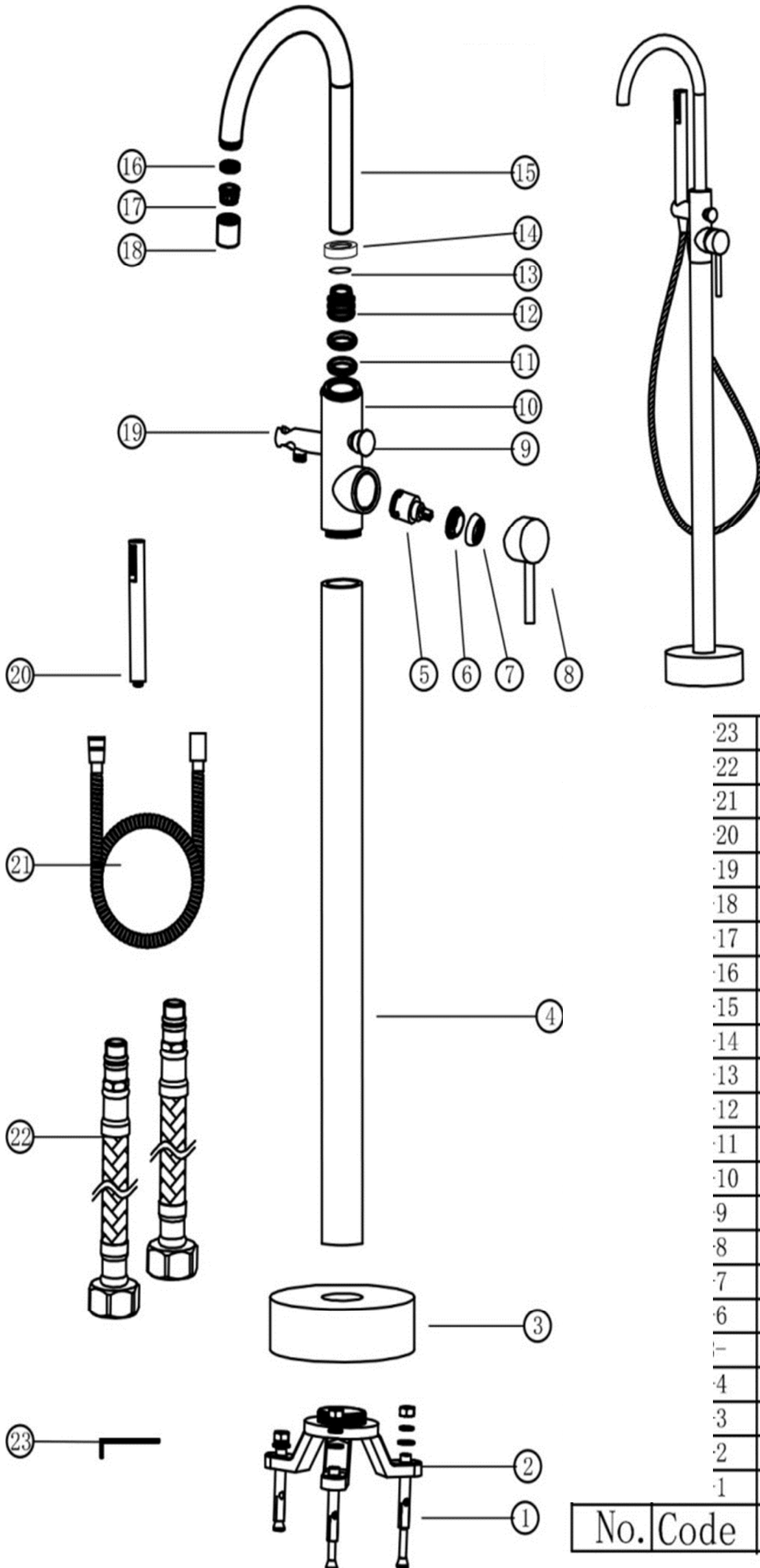

·23	Hex key	1
·22	Flexi tails	2
·21	Hose	1
·20	Handset	1
·19	Handset bracket	1
·18	Aerator cap	1
·17	Aerator	1
·16	O ring	1
·15	Spout	1
·14	Collar	1
·13	Washer	1
·12	Brass nut	1
·11	O ring	2
·10	Body	1
·9	Diverter cap	1
·8	Handle	1
·7	Chrome collar	1
·6	Brass nut	1
·5	Cartridge	1
·4	Stand pipe	1
·3	Base plate	1
·2	Fixing anchor	1
·1	Fixing bolt	3

No.	Code	Name	Qty
-----	------	------	-----