

# SAGITTARIUS

## TAPS & SHOWERING

**Construction** Brass Body CuZn40Pb2, EN CW617N (equivalent to BS CZ122)  
Zinc alloy Handle  
**Finishes** Chrome plated to BS EN 248  
**Product Type** Contemporary  
**Water Pressure** Min. 0.1 bar, Max. 6.0 bar  
**Plumbing Systems** Suitable for all plumbing systems  
**Standards** Complies with BS5412, BS EN200

**Cartridge** 1/4 Turn 3/4" Ceramic Disc Valves  
**Aerator** Aerator spout  
**Fitting** Brass 3/4" BSP Tails  
**Packaging** 49.5x41.5x33cm / carton (8 boxes / carton), Weight: 1.74kg/box  
**Guarantee** 10 years against manufacturing faults (excluding serviceable parts).

### PIAZA BATH FILLER

### CHROME

### PI/104/C

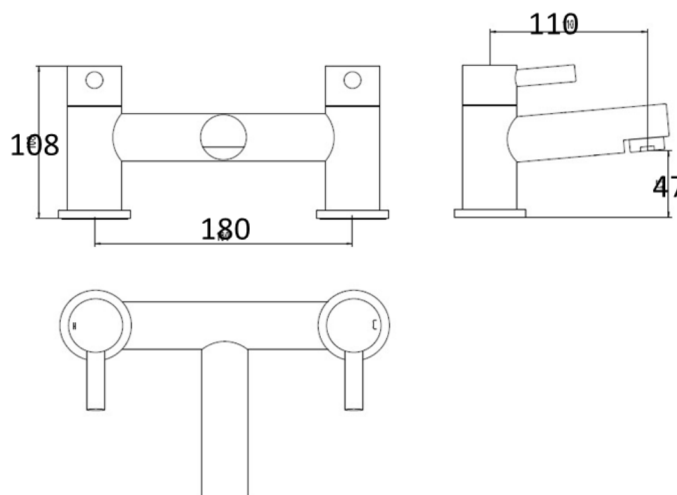
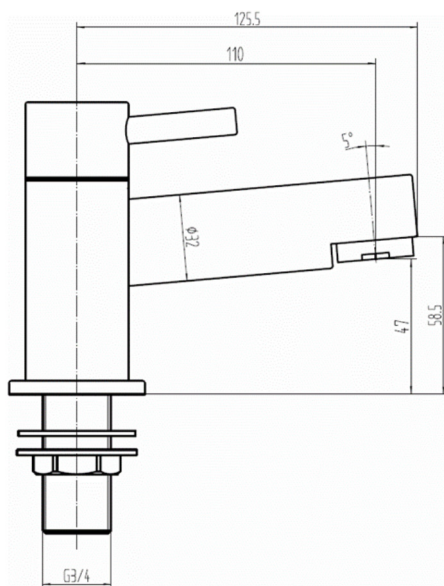
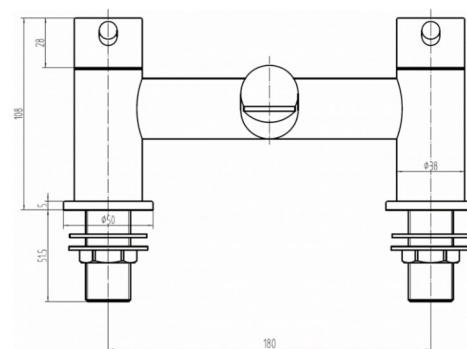

### Flow Rates (Litres per minute)

System Pressure	0.1 Bar	0.2 Bar	0.3 Bar	0.5 Bar	1.0 Bar	1.5 Bar	2.0 Bar	3.0 Bar	4.0 Bar	5.0 Bar
PI/104/C	8.52	8.65	-	10.30	11.90	13.80	15.30	19.00	-	-

The information contained on this page was correct at the date of issue. Fitting dimensions are provided as a guide only. Some variation may occur due to manufacturing tolerances.  
We pursue a policy of continuing improvement in design and performance of our products and so reserve the right to change specifications without prior notice

FOR FURTHER ADVICE PLEASE CONTACT :-

SAGITTARIUS LTD UNIT 1 LOWER VICTORIA STREET—CHADDERTON—OLDHAM—OL9 9TU TEL:0616 6202029

EMAIL:TECHNICAL@SAGITTARIUSTAPS.CO.UK

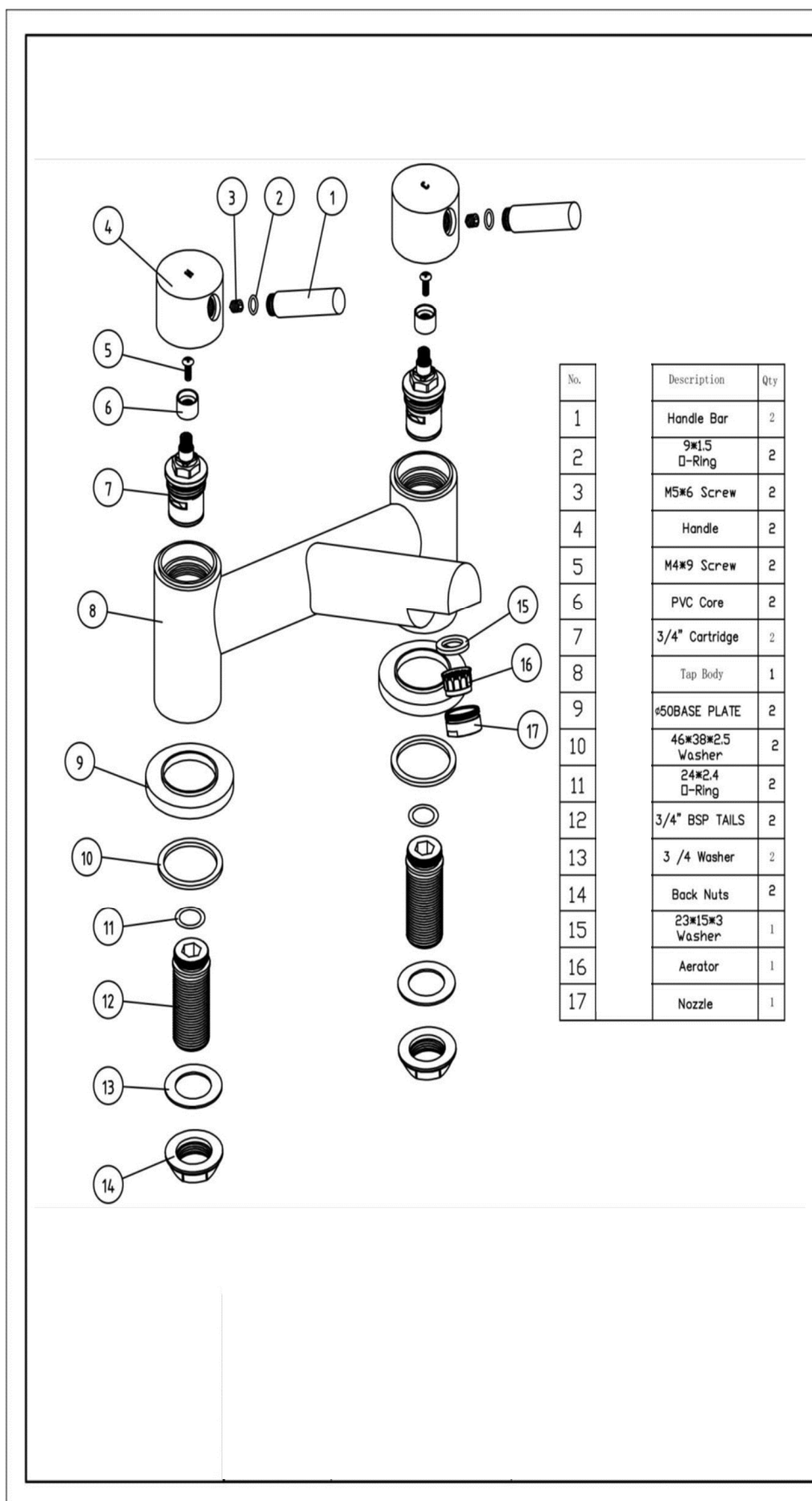

The information contained on this page was correct at the date of issue. Fitting dimensions are provided as a guide only. Some variation may occur due to manufacturing tolerances.  
We pursue a policy of continuing improvement in design and performance of our products and so reserve the right to change specifications without prior notice

FOR FURTHER ADVICE PLEASE CONTACT :-  
SAGITTARIUS LTD UNIT 1 LOWER VICTORIA STREET—CHADDERTON—OLDHAM—OL9 9TU TEL:0616 6202029  
EMAIL:TECHNICAL@SAGITTARIUSTAPS.CO.UK