

No.	Description	Product Code	Fixings included	Gross Weight	Net Weight
1	Cistern inc. Flush Fitting & Lid	C100S	Yes	11.4kg	---
2	Toilet Seat	TS100S	Yes	3.1kg	---
3	Short Projection WC Pan	P100S	Yes	21.2kg	---



Cistern Settings:

Full Flush Volume: 6L
Reduced Flush Volume: 4L

Floor Fixing Kit:

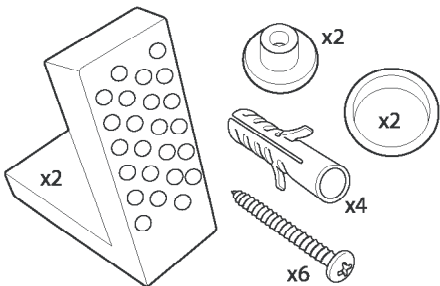

Also Available:

Soft close thermoset toilet seat | TS100WSC

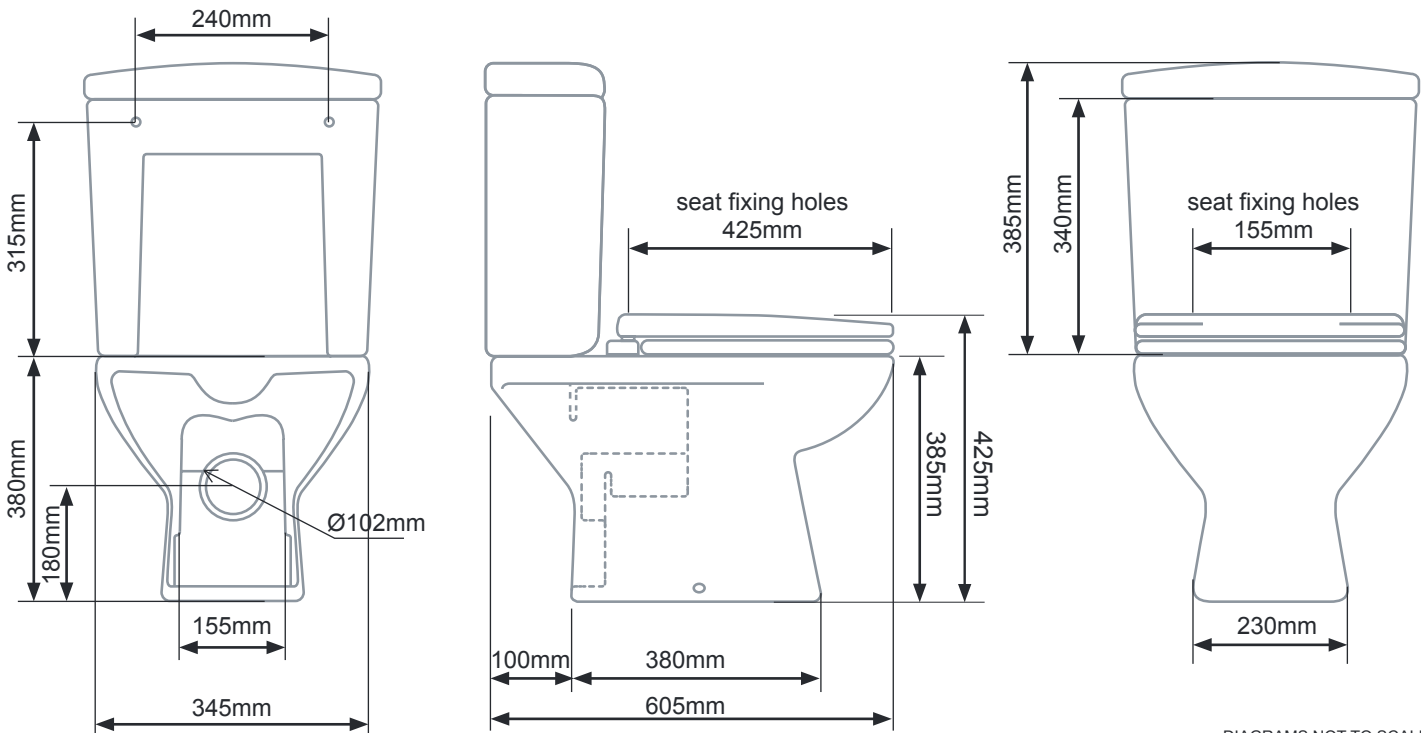

DIAGRAMS NOT TO SCALE
ALL DIMENSIONS IN MM
TOLERANCE OF ± 5MM

FAQ's

What side is the inlet located? **Right hand side**
Are there any other compatible seats? **TS100 and TS100WSC (soft close) only**
Can this pan be used with a side connection outlet pipe? **Yes**
The cistern lid won't shut/the cistern isn't working correctly. **Ensure the inlet and flush valves are set to the correct heights. See "Cistern Settings" above.**

No.	Description	Product Code	Fixings included	Gross Weight	Net Weight
1	Toilet Seat	TS100S	Yes	3.1kg	2.9kg
2	Wall Hung Pan	BTW100S	Yes	20.2kg	--



Also Available:

Soft close thermoset toilet seat | TS100WSC

Floor Fixing Kit:

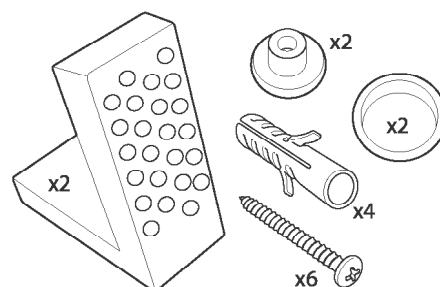

DIAGRAMS NOT TO SCALE
ALL DIMENSIONS IN MM
TOLERANCE OF ± 5 MM

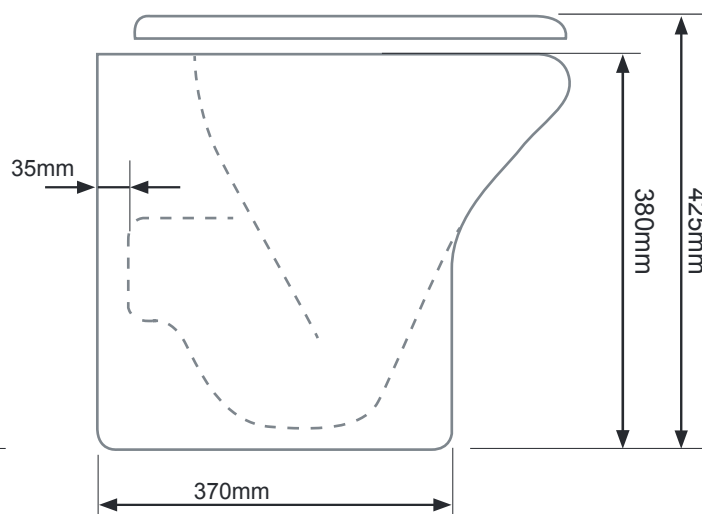
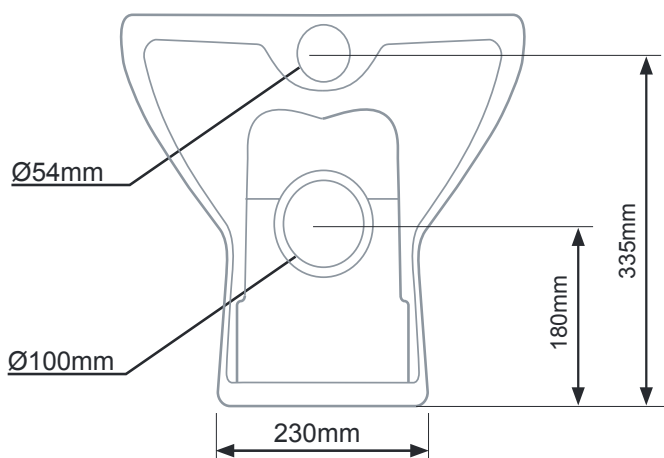
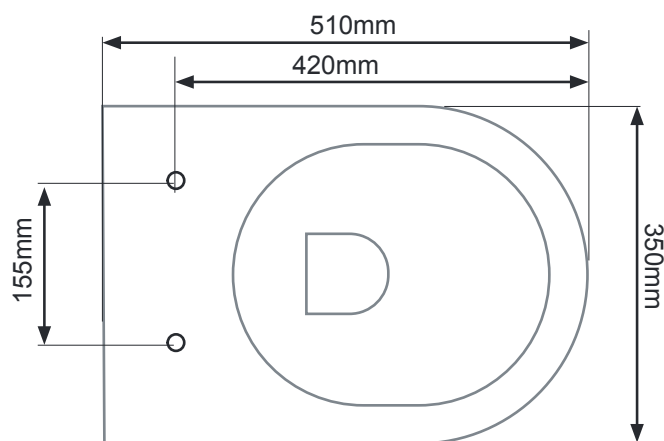

FAQ's

What side is the inlet located? **Right hand side**

Can this pan be used with a side connection outlet pipe? **NO**

Are there any other compatible seats? **TS100 and TS100WSC (soft close) only**

No.	Description	Product Code	Fixings included	Gross Weight	Net Weight
1	450mm Basin	SB145S	NO	13kg	--
2	565 mm Basin	SB100S	NO	15.4kg	--
3	Full Height Pedestal	PE100S	NO	12.7kg	--



Pedestal Size:
180mm (w) x 160mm (d) x 725mm (h)

Also Available:

450 two tap hole basin | DB145
565 two tap hole basin | DB100



TRAP 6:

SB145 AND DB145 can be installed with a bottle trap

450 MM BASIN

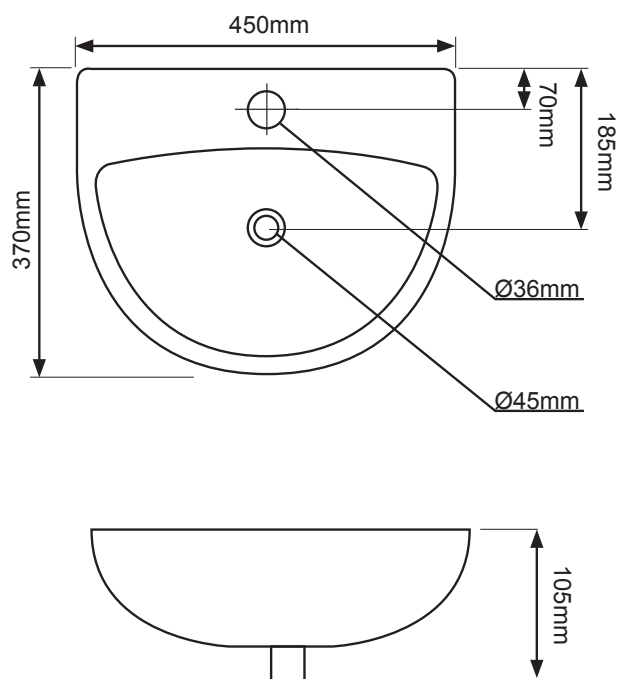

Bowl Depth: 130 mm
Total Height of Ped & Basin: 840 mm

565 MM BASIN

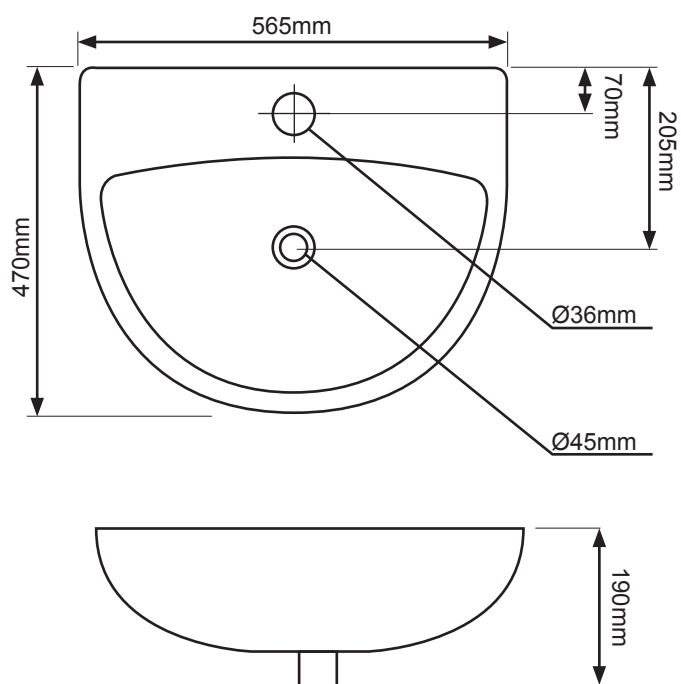

Bowl Depth: 150mm
Total Height of Ped & Basin: 860 mm

DIAGRAMS NOT TO SCALE | ALL DIMENSIONS IN MM | TOLERANCE OF ± 5MM

No.	Description	Product Code	Fixings included	Gross Weight	Net Weight
1	510 mm Slimline Basin (2 Tap Holes)	SDB100S	NO	12.6kg	--
2	Bottle Trap	TRAP 6	NO	--	--

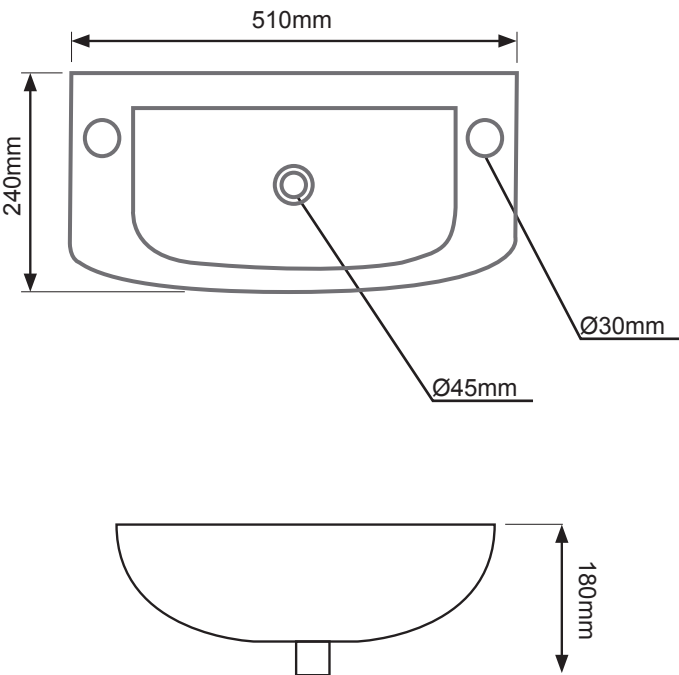
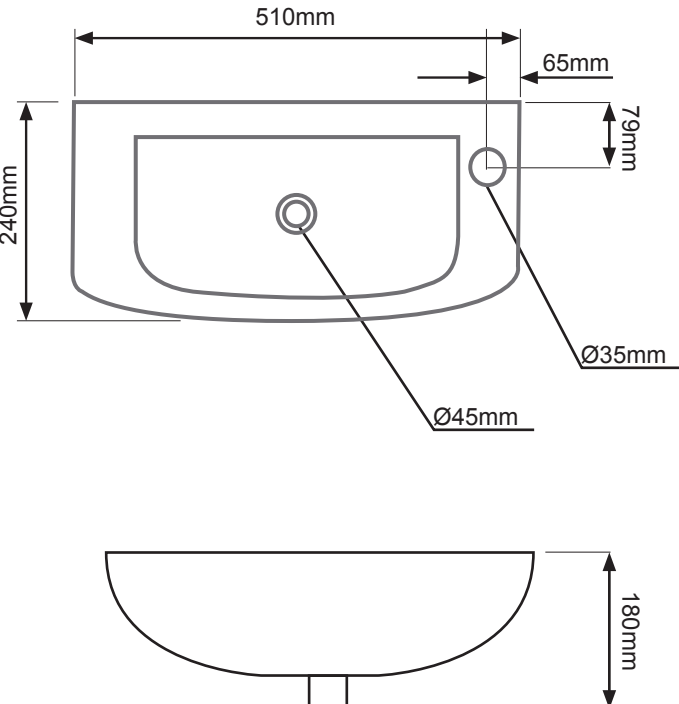

Also Available:
510 mm Slimline Basin RH Single Tap Hole | SSRB100
510 mm Slimline Basin LH Single Tap Hole | SSLB100

510 MM TWO TAP HOLE	510 MM SINGLE TAP HOLE (RIGHT HAND SHOWN)
	
Bowl Depth: 140mm	Bowl Depth: 140mm

DIAGRAMS NOT TO SCALE | ALL DIMENSIONS IN MM | TOLERANCE OF ± 5MM

No.	Description	Product Code	Fixings included	Gross Weight	Net Weight
1	575 mm Corner Basin	CB100S	NO	10.4kg	--
2	Bottle Trap	TRAP 6	NO	--	--

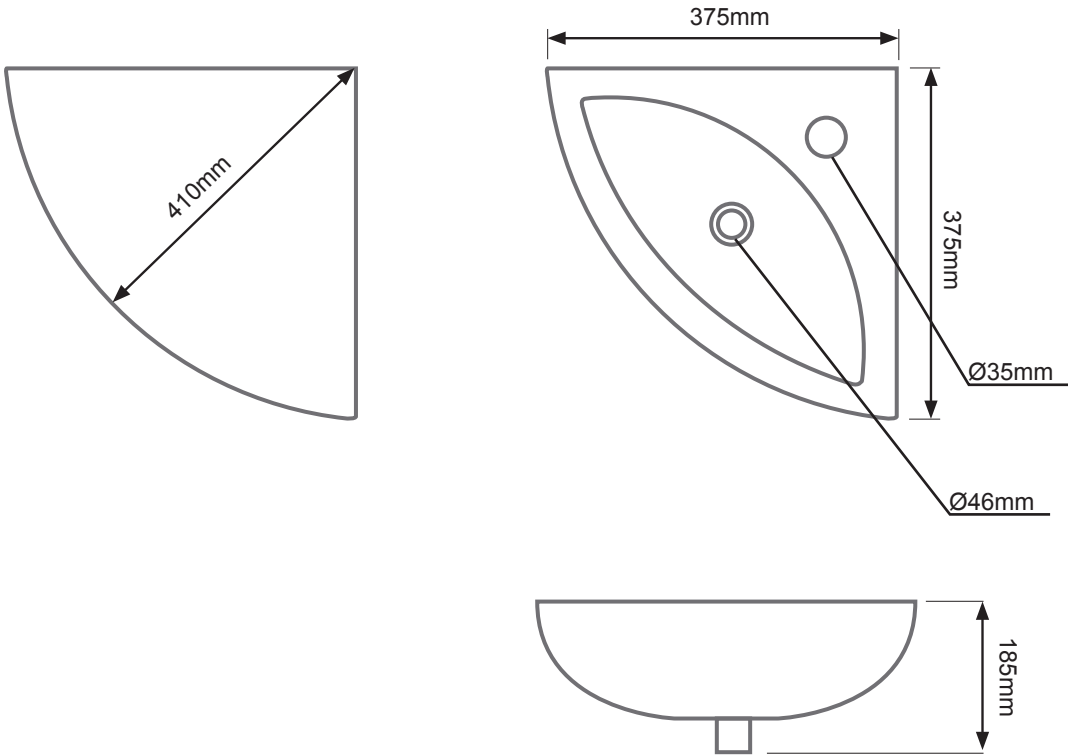

Bowl Depth: 145mm

DIAGRAMS NOT TO SCALE | ALL DIMENSIONS IN MM | TOLERANCE OF ± 5MM

No.	Description	Product Code	Fixings included	Gross Weight	Net Weight
1	560 SEMI COUNTERTOP BASIN	SCSB100S	YES	15.5kg	---

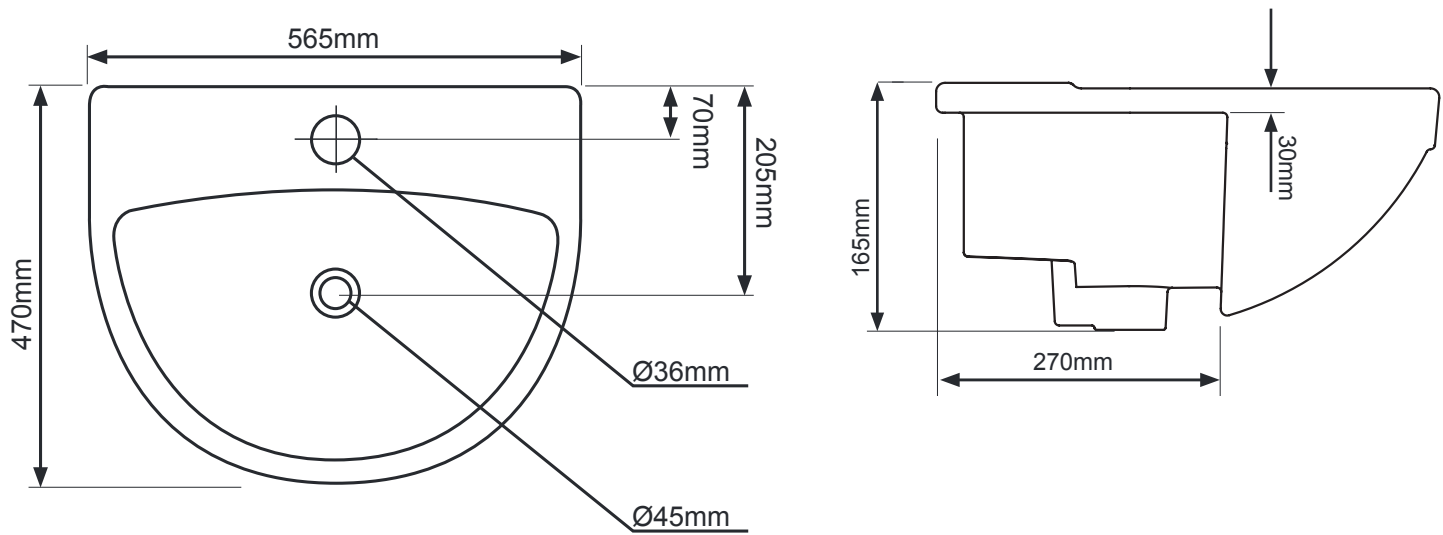

Bowl Depth: 125mm

DIAGRAMS NOT TO SCALE | ALL DIMENSIONS IN MM | TOLERANCE OF ± 5MM

No.	Description	Product Code	Fixings included	Gross Weight	Net Weight
1	Cistern inc. Flush Fitting & Lid	C100S	Yes	11.4kg	---
2	Toilet Seat	TS100S	Yes	3.1kg	---
3	Comfort Height Close Coupled Pan	PC100S	Yes	---	---



Cistern Settings:

Full Flush Volume: 6L

Reduced Flush Volume: 4L

Floor Fixing Kit:

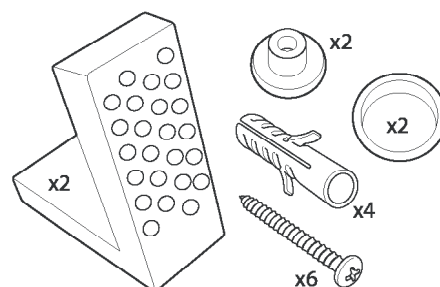

Also Available:

Soft close thermoset toilet seat | TS100WSC

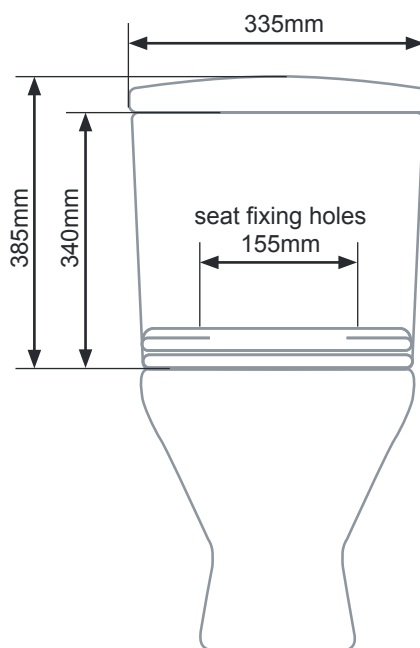
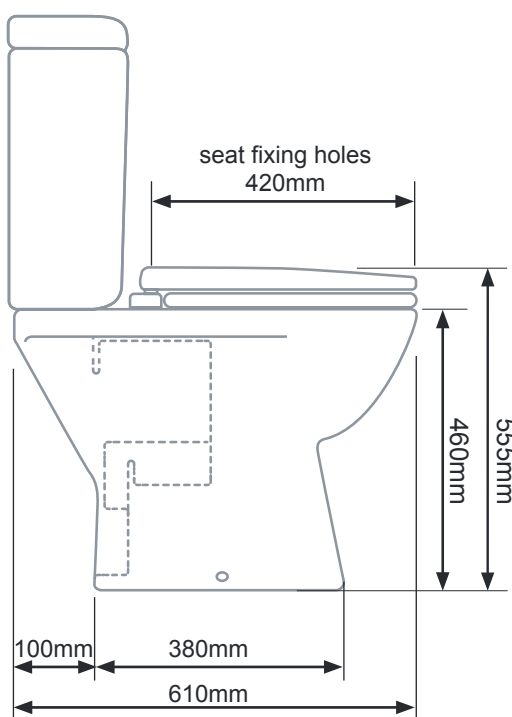
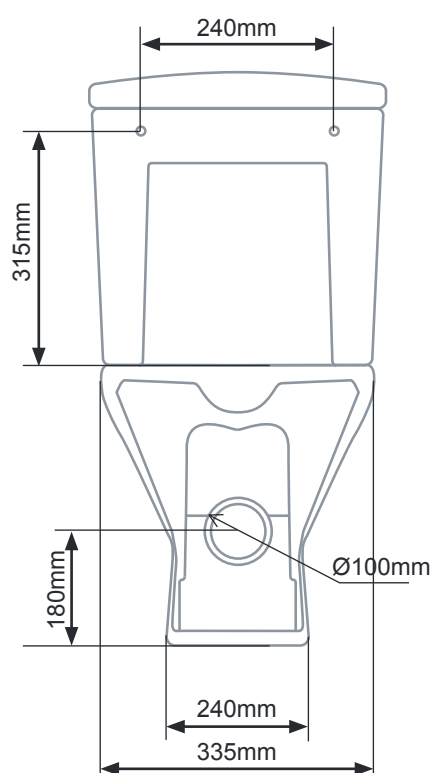

FAQ's

What side is the inlet located? **Right hand side**

Are there any other compatible seats? **TS100 and TS100WSC (soft close) only**

Can this pan be used with a side connection outlet pipe? **Yes**

The cistern lid won't shut/the cistern isn't working correctly. **Ensure the inlet and flush valves are set to the correct heights. See "Cistern Settings" above.**

No.	Description	Product Code	Fixings included	Gross Weight	Net Weight
1	Toilet Seat	TS100S	Yes	3.1kg	2.9kg
2	Wall Hung Pan	WH100S	Yes	--	--



Also Available:

Soft close thermoset toilet seat | TS100WSC

wall fixings included

DIAGRAMS NOT TO SCALE
ALL DIMENSIONS IN MM
TOLERANCE OF ± 5MM

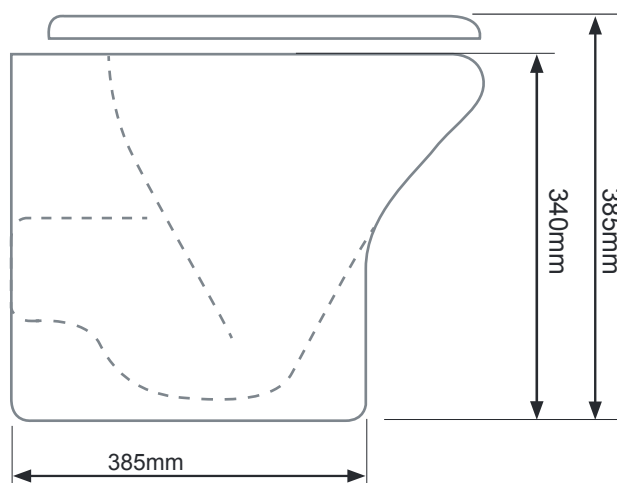
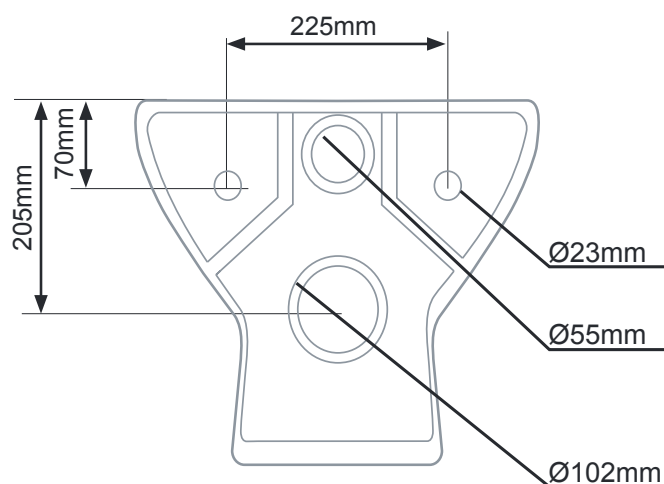
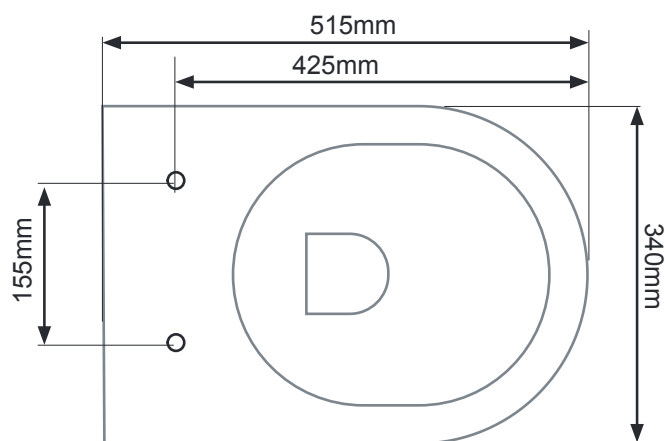

FAQ's

What side is the inlet located? **Right hand side**

Can this pan be used with a side connection outlet pipe? **NO**

Are there any other compatible seats? **TS100 and TS100WSC (soft close) only**