

sola non-concussive tap

water saving operation
temperature controlled when fitted with mixing valve
complete with flow straightener



Non-concussive monobloc

to specify/order:

Please use the product reference shown below.

temperature controlled non-concussive monobloc

Single **SF2104CP**
Flow restrictor 2.0 LPM x2 **SF0200XX**

thermostatic mixing valve

Single applications - 15mm **SF1037XX**

finish

Chrome plated CP.

approvals

HBN 00-10 C, code TPP1
TMV2 & TMV3 Approved
when installed with SF1037XX



recommended operating pressure

Minimum operating pressure 0.5 bar (dynamic).
Maximum operating pressure 5 bar.

note

At an inlet pressure of 1 bar taps
give approximately 15 seconds
(+or - 3 seconds) of flow after button
is pressed.

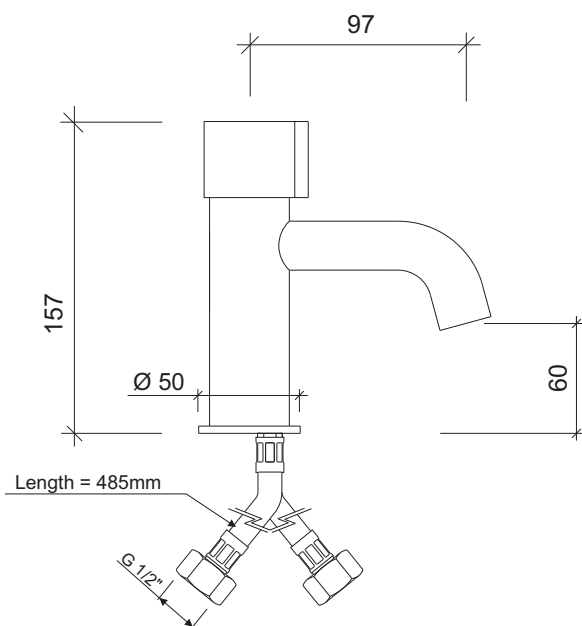

Flow Rate (Litres per minute)	0.5 Bar	1.0 Bar	2.0 Bar	3.0 Bar	4.0 Bar	5.0 Bar
Standard	5.1	7.2	10.7	13.5	16.2	18.5
Flow Limiter Fitted (Part No:SF0200XX)	2.0	2.1	2.2	2.39	2.7	2.7

All measurements shown are in millimetres. Drawing sizes are not to scale.



Hotels



Healthcare



Education



Commercial

Twyford
Geberit Group