

Twyford

e200

Washbasin Cabinet

Installation Instructions

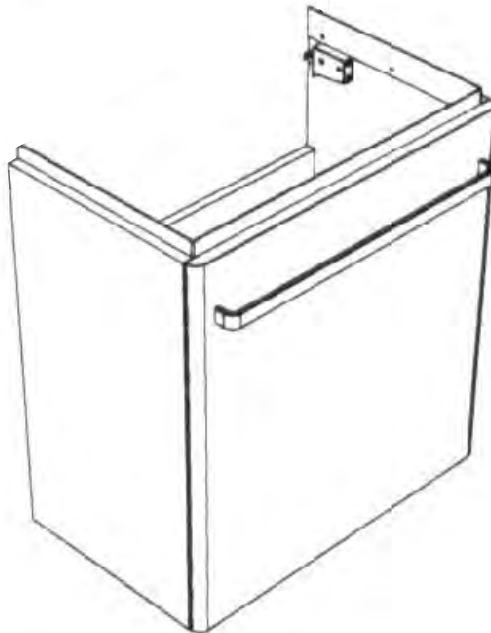

Check The product prior to installation, making sure all the components are present, and for any visible damage. We cannot accept responsibility for damage or visible faults discovered after installation.

Please leave this instruction and care details with the end user

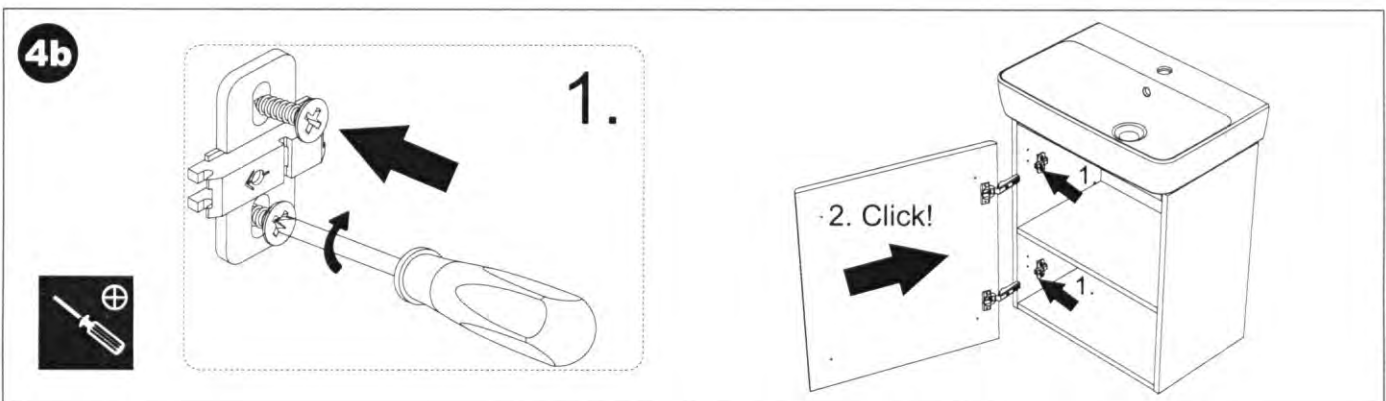
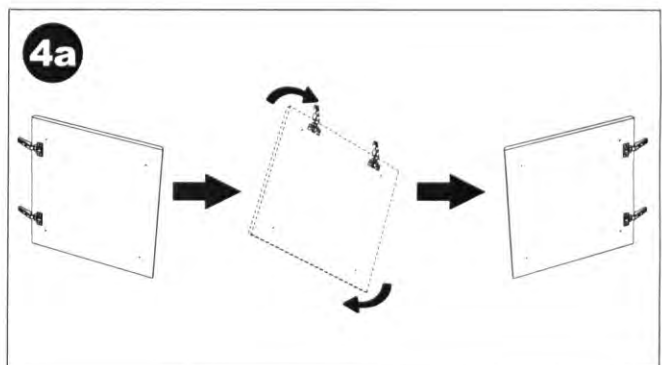
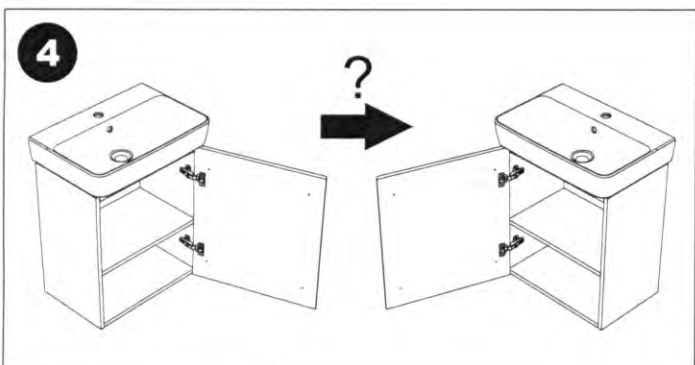
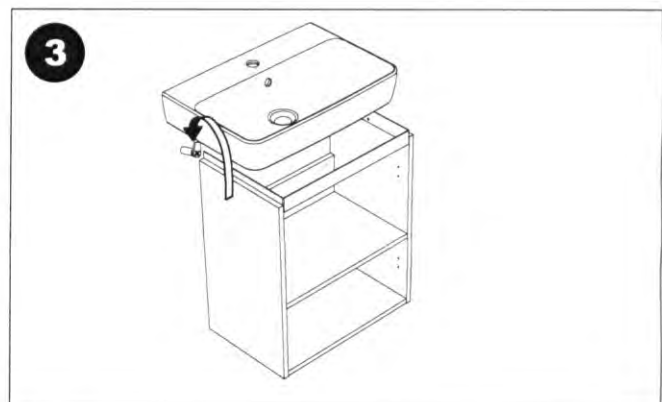
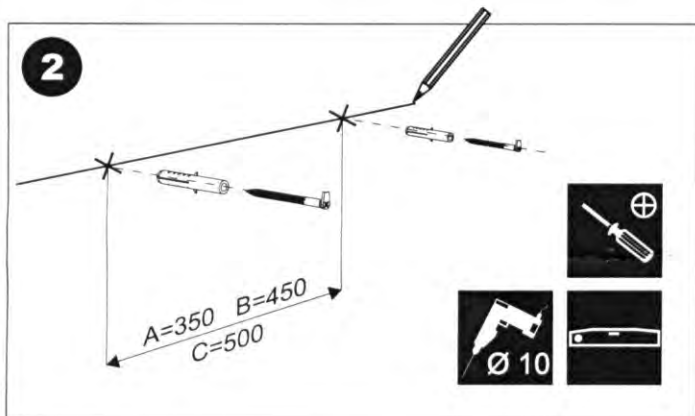
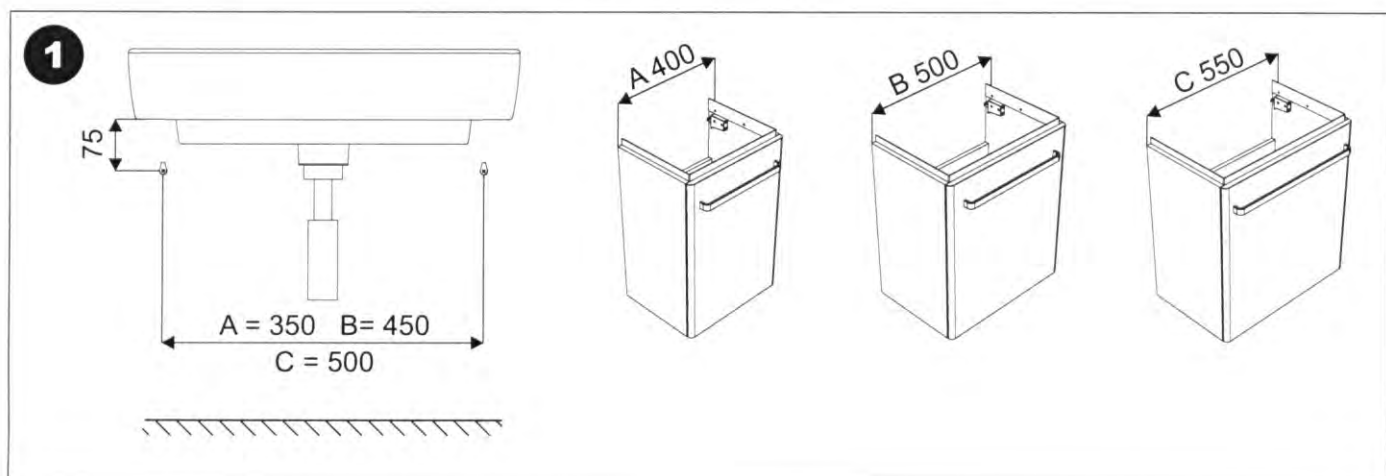
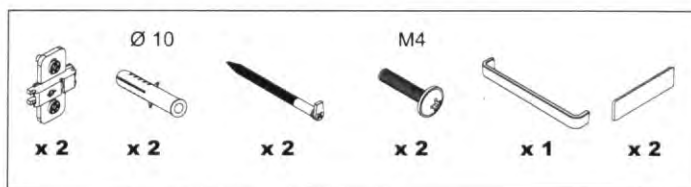

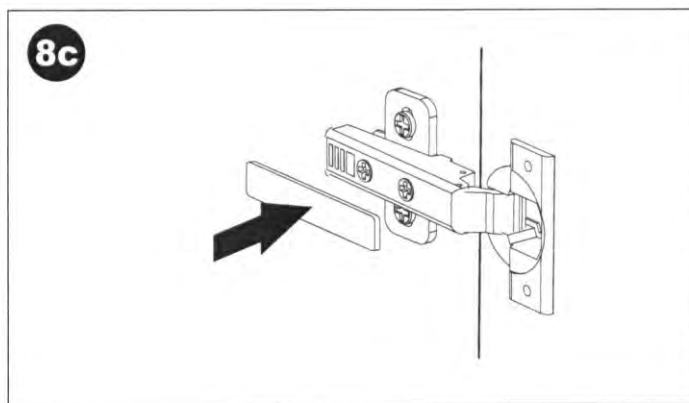
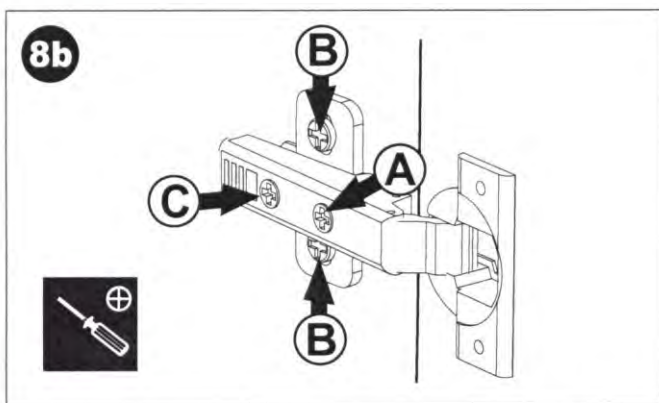
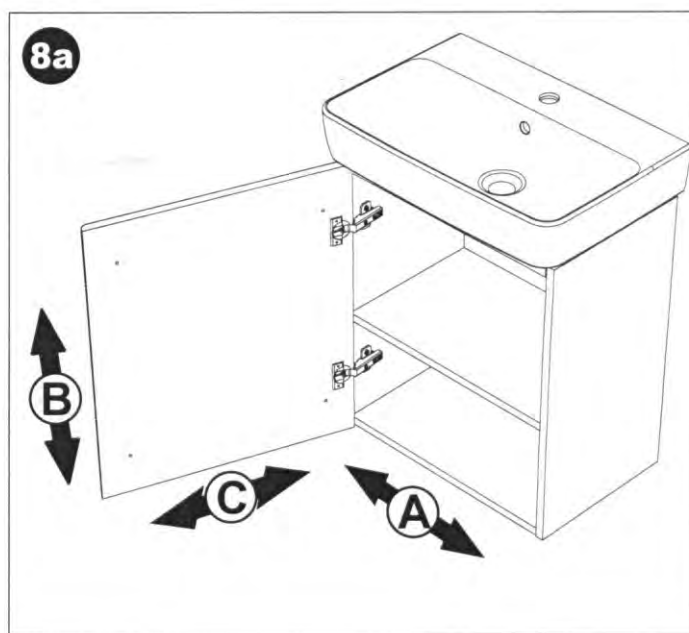
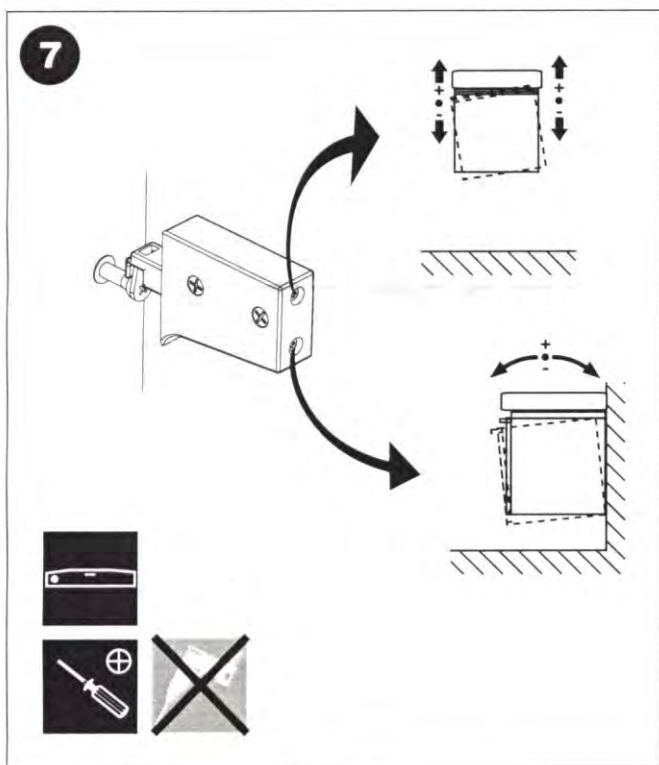
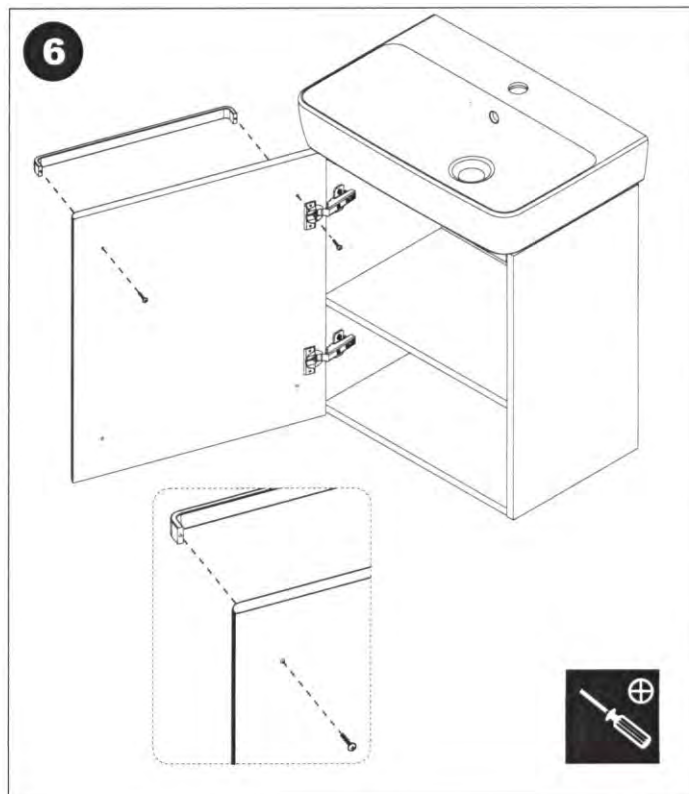
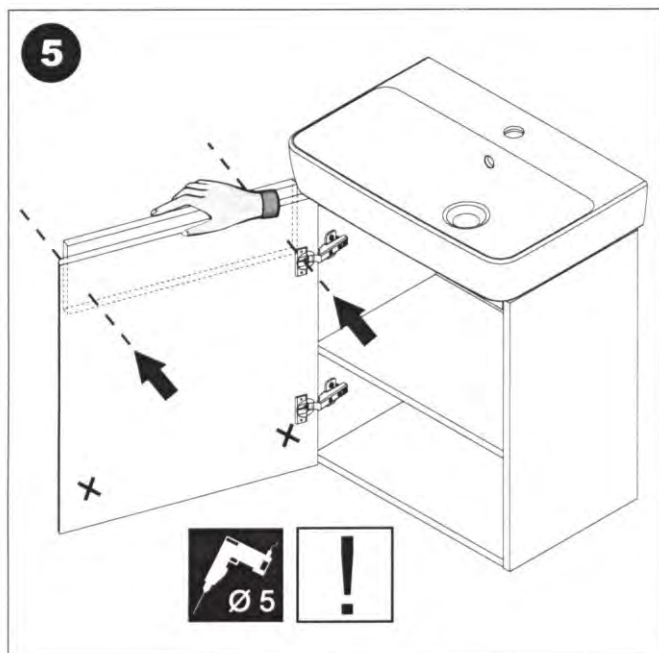

Cleaning and Care Instructions - Bathroom Furniture

- Bathroom furniture should be cleaned with a soft dry cloth. Avoid abrasive or sharp objects.
- For removing stubborn dirt, dampen a cloth with warm water and a mild household detergent. Dry surface thoroughly afterwards.
- Furniture should never be cleaned with cleaners containing acid or solvents. Abrasive cleaners should be avoided.
- Wipe up any standing water immediately after use.
- Any chemicals, such as nail varnish remover, hair dyes, bleach or anti- lime scale remover, spilled onto the furniture should be removed straight away.
- Any scratches of the furniture finish should be sealed to avoid water ingress.

Furniture Colour

- Furniture colour may vary slightly from the colour sample
- Lacquered and veneered surfaces are subject to aging and their colour can change over time.
- Continuous exposure to direct sunlight (UV radiation) can speed up the aging process.

Guarantee

- For information relating to the guarantee offered with this product please go to:-
www.twyfordbathrooms.com

Twyford
bathrooms

TWYFORD BATHROOMS LAWTON ROAD, ALSAGER, STOKE ON TRENT ST7 1LR

TEL: +44 (0) 1270 879777

FAX: +44 (0) 1270 873864

WEB: www.twyfordbathrooms.com