



M A N U A L

FRONTLINE®
the complete bathroom

D Shape Cabin (R9)

Installation instruction

Aquaglass Purity D shape cabin

Adjustment: -40 x (-25~ -20mm) x 1950mm

Mounting preparation:

After opening the package, read the instructions carefully, check whether all parts are present and there are no sign of shipping damage. If you find any problem, please contact your retailer directly.

Necessary tools: electric drill, masonry drill(ϕ 6mm), drill(ϕ 3.2mm), cross tip screw driver, spirit level, tape measure, rubber hammer, knife, pencil and silicone sealant.

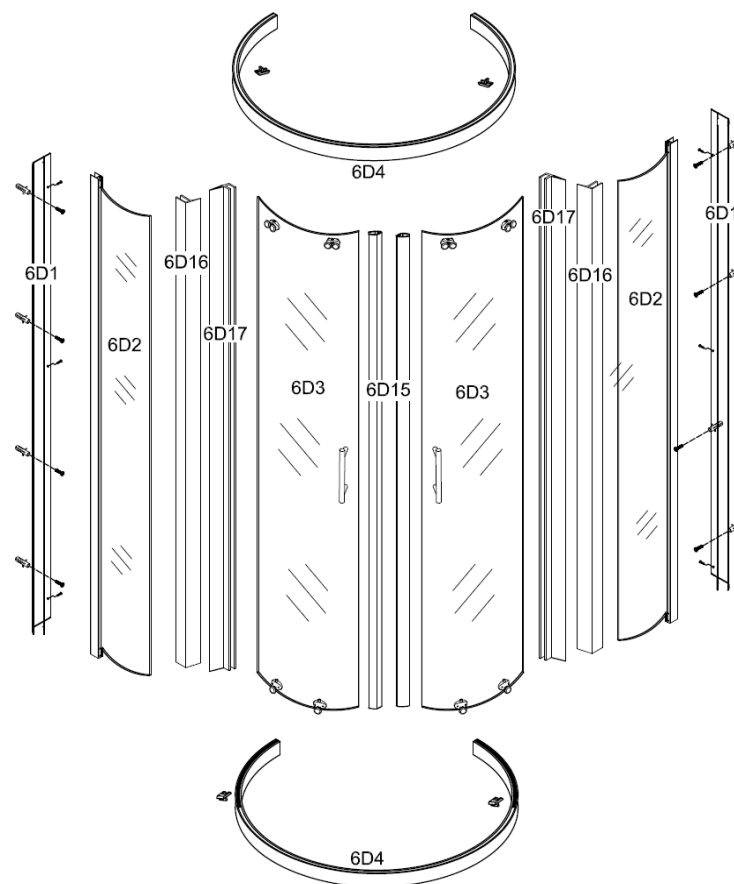
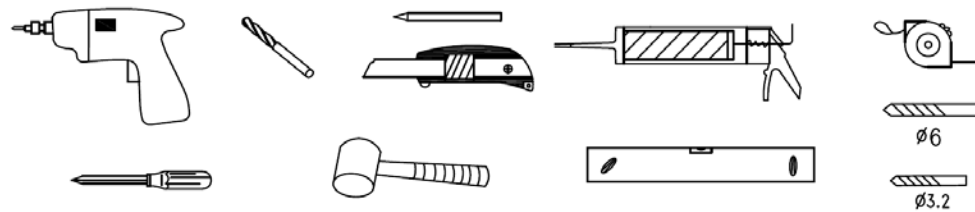

6D5 ST4 x6	6D6 ST4 x8	6D7 ST4 x8	6D8 x4	6D9 x8
6D10 x14	6D11 ST4 x8	6D12 x4	6D13 x4	6D14 x2

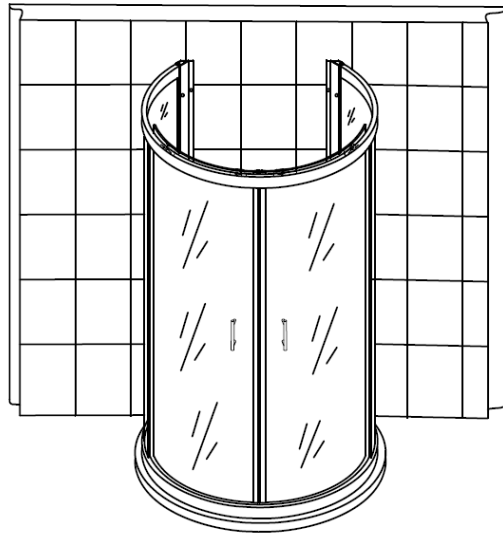

1



1. Measure the ground with spirit level to make sure ground is in level. Put the wall profiles (6D1) against the wall, ensuring the distance between the profile and the wall is correct. Adjust the profile to make sure it is vertical by using a spirit level. Mark the holes on the wall.

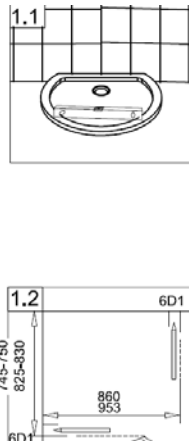

2

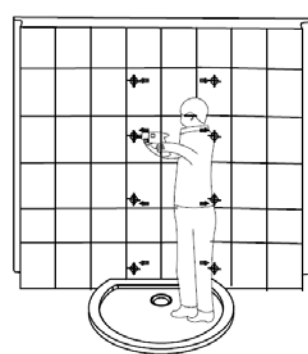

2. Drill the holes ($\varnothing 6\text{mm}$) according to the marks and insert the wall plugs (6D9) into the holes

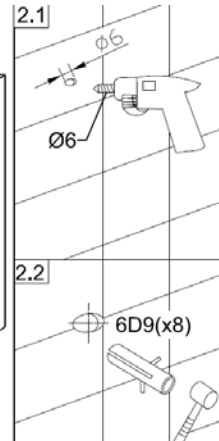

3

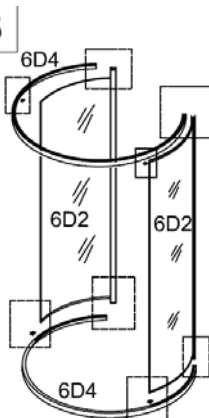

3. Insert fixing part 6D8 into rail profiles 6D4. Put rail profiles on the top and bottom of fixing panel 6D2.

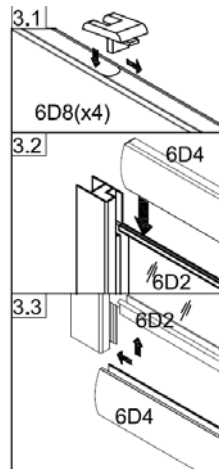

4

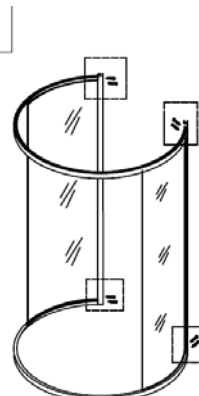

4. Fasten rail profile and vertical profile together with screw 6D7.

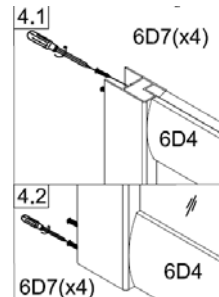

5

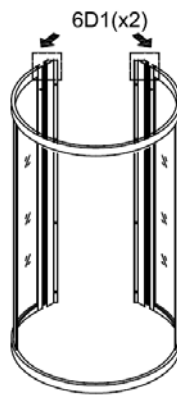

5. Put wall profile 6D1 on the 2 sides of frame.

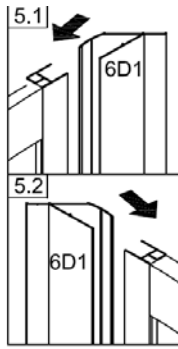

6

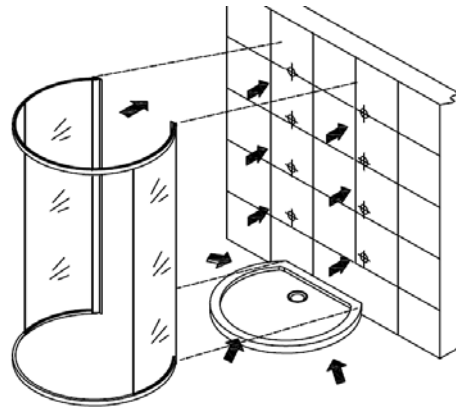

6. Move the frame onto the wall.

7

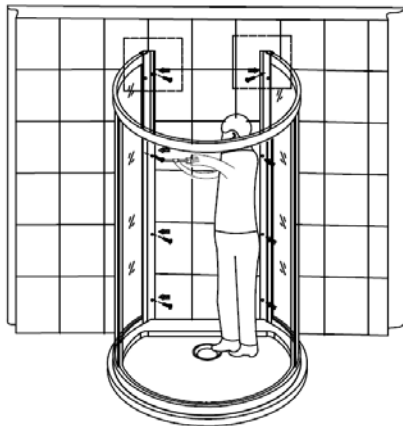

7. Inside of cabin, fasten wall profile on the wall with screw 6D6 and screw cap 6D10.

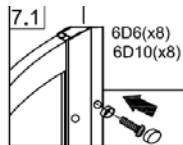

8

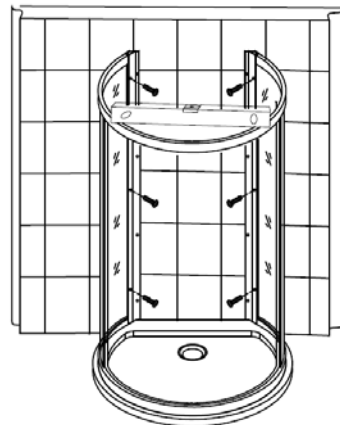

8. Inside of cabin, drill the vertical profile into wall profile. Fasten profiles with screw 6D5 and screw cap 6D10.

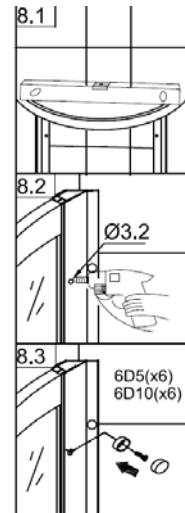

9

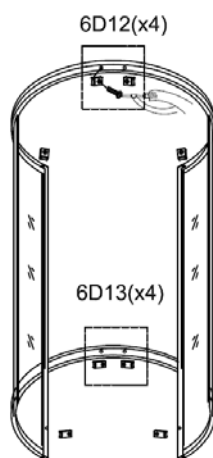

9. Mount stopper 6D12 on top rail profile and 6D13 on bottom rail profile with screw 6D11.

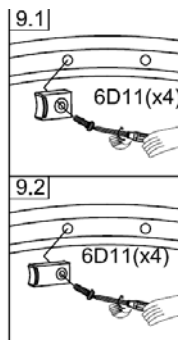

10

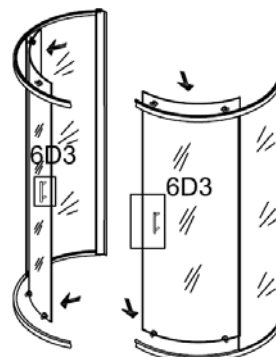

10. Mount handle 6D14 on sliding panel 6D3. Put top roller into track of top rail profile. Press bottom roller and insert into track of bottom rail profile.

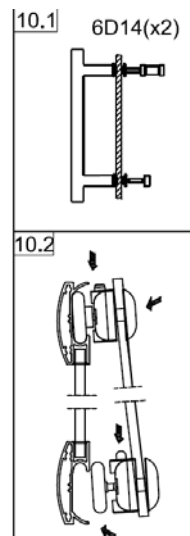

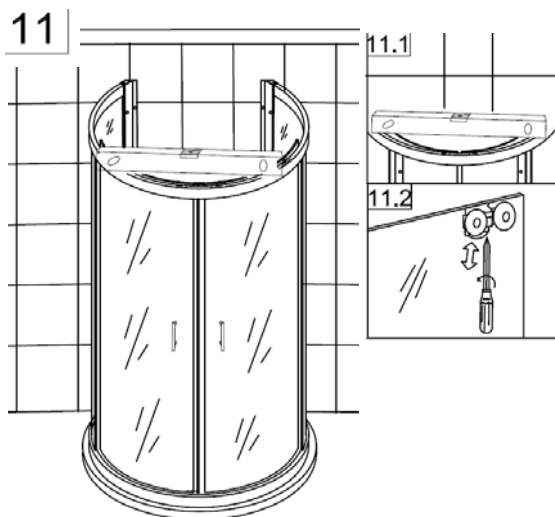

11. Put spirit level on top of sliding panels. Adjust the rollers with driver to make sure sliding door vertical for better sliding effect.

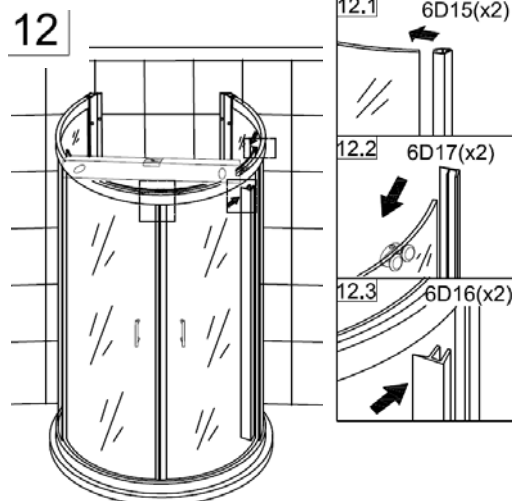

12. Apply magnetic sealer 6D15 on the sliding door closing side. Apply vertical sealer on the other side of sliding panel and the fixing panel edge.

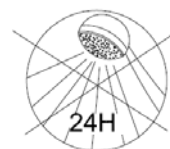
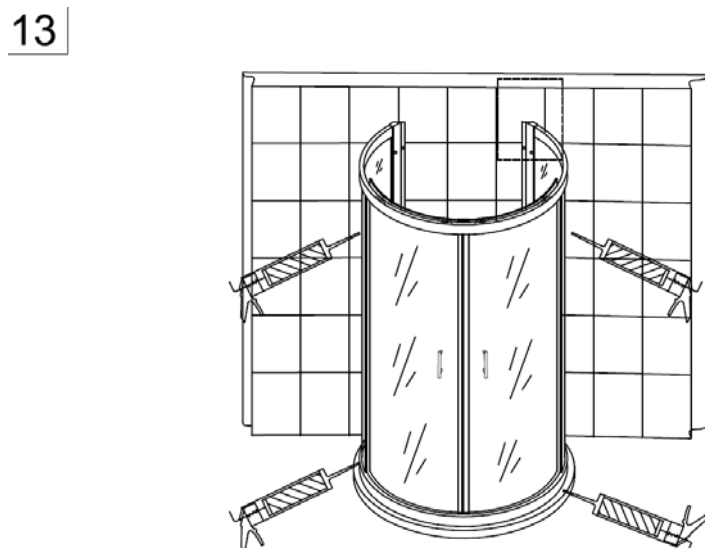

13. From outside the enclosure, seal down the whole length of the join between the wall profile and the wall. Please do not use showering within 24 hours after silicon sealing.

Cleaning and Maintenance:

Please do not use abrasive or strong cleaning solutions on the shower enclosure, such as alcohol, petroleum liquids or any other chemical cleaner.

Should there be any dirty stains on the shower enclosure, please clean it with a soft lint free cloth and warm soapy water. Please rinse it with clean water afterwards. After the installation is complete, if there is any noise during glass door movement, please add a small quantity of lubricant onto the roller wheel, bottom guide and track.

For information and support: phone 0845 470 24 27

V14E22